

# MOUNTZ ASSEMBLY POWER TOOLS



# TABLE CONTENTS

<b>Products</b>	<b>Page</b>
BF-Series Electric Screwdrivers	
BF Mini models	4
BF Standard models	5
BF Standard Plus models	6
BF Soft Stop models	7
BF Soft Stop Plus models	8
BF Angle & Auto Reverse models	9
BFA-Series Robotic Screwdrivers	10
NF-Series Electric Screwdrivers	
NF Standard models	11
NF Standard Plus models	12
NF Soft Stop models	13
NF Angle & Auto Reverse models	14
NFA-Series Robotic Screwdrivers	15
HF-Series Electric Screwdrivers	16
LF-Series Electric Screwdrivers	17
EF-Series Electric Screwdrivers	18
K-Series Electric Screwdrivers	19
E-Series Electric Screwdrivers	20
BL-Series Electric Screwdrivers	21
BLG-Series Electric Screwdrivers	22
BLG-BC-1 Series Electric Screwdrivers	23
CL-Series Electric Screwdrivers	24
VB-Series Electric Screwdrivers	25
STC30 Plus Transformer	26
ET-30D Mini Transformer	27
STC40 Transformer	28
STC40-FA Transformer	29
FT-30D Mini Transformer	30

# TABLE CONTENTS

<b>Products</b>	<b>Page</b>
CLT-60 and CLT-80 Transformers	31
T-45BL and T-70BL Transformers	32
CLT-70STC3 and BLOP-STC3 Transformer	33
Scout Screw Counter	34
XP Air Screwdrivers	
XP In-Line models	35
XP Pistol Grip models	36
XP Right Angle models	37
Flex Power Pulse Tools	
In-Line Auto Shut-Off models	38
In-Line Non Shut-Off models	39
Pistol Grip Auto Shut-Off models	40
Pistol Grip Non Shut-Off models	41
Right Angle Auto Shut-Off models	42
Right Angle Non Shut-Off models	43
Tool Balancers	
Zero Gravity balancers	44
Retractor balancers	45
Air Hose Reel balancers	46
Tool Positioner balancers	47
EZ-Glider Torque Arms	
Linear torque arms	48
Articulated torque arms	50
Telescoping torque arms	51
Inverted Telescoping torque arms	52
Position Control torque arms	54
Telescoping Position Control torque arms	55
MSP Screw Presenters	58
MSP Automation Screw Presenters	59
Webinars on Assembly Power Tools	60

# BF-SERIES BRUSHLESS ELECTRIC SCREWDRIVERS

## (Mini Soft Stop Models)

- Various models that range from 0.17 - 3.9 lbf.in
- Adjustable RPM setting on the tool. A selectable Soft Start mode from 0.2-0.6 seconds.
- Precision “Soft Stop” clutch prevents shock to sensitive assemblies like disk drives, plastics, electronics, etc.
- High-performance Swiss Maxon brushless motors are engineered for higher efficiency and performance. External torque adjustment scale.
- Lower maintenance requirements and expenses. Longer lifespan (no brush and commutator erosion)
- Ensures accuracy in fastening with precision automatic shut-off clutch once preset torque is achieved.
- It can be connected with the Scout Screw Counter. Requires an STC40 or FT-30D transformer (power supply).
- All models are ESD designed and prevent electrostatic discharge, which improves production yields, manufacturing costs, product quality, product reliability, reputation, and profitability.



### Torque Ranges

Models	Driver Type	Item #	lbf.in	cN.m	Adjustable RPM	Grip Dia	Drive Size
BF035 ESD	Lever Start	145844	0.17 - 3	2 - 34.3	300 - 1100	1 1/5"	4mm Hios Dr.
BF045 ESD	Lever Start	145845	0.35 - 3.9	4 -44.1	300 - 700	1 1/5"	4mm Hios Dr.

### Related Products



**Transformers (Power Supplies)**  
Requires transformer to operate.

**STC40 Transformer**  
Item # 145754



**FT-30D Transformer**  
Item # 145870



**Torque Cover**  
Protects from incidental or operator tampering of torque setting.

**Item # 145773**  
For: Mini BF-Series models



**Program Lock Key**  
Item # 145774

To adjust RPM & soft start settings the Program Lock Key must be plugged into the STC40 Transformer.

# BF-SERIES BRUSHLESS ELECTRIC SCREWDRIVERS

## (Standard Models)

- Various models that range from 0.9 - 10.4 lbf.in
- Adjustable RPM setting on the tool. A selectable Soft Start mode from 0.2-0.6 seconds.
- High-performance Swiss Maxon brushless motors are engineered for higher efficiency and performance. External torque adjustment scale.
- Lower maintenance requirements and expenses. Longer lifespan (no brush and commutator erosion)
- Ensures accuracy in fastening with precision automatic shut-off clutch once preset torque is achieved.
- It can be connected with the Scout Screw Counter. Requires an STC40 transformer (power supply).
- All models are ESD designed and prevent electrostatic discharge, which improves production yields, manufacturing costs, product quality, product reliability, reputation, and profitability.



### Torque Ranges

Models	Driver Type	Item #	lbf.in	cN.m	Adjustable RPM	Grip Dia	Drive Size
BF060 ESD	Lever Start	145884	0.9 - 5.2	9.8 - 58.8	700 - 1600	1 1/4"	1/4" F/Hex
BF060P ESD	Push-to-Start	145885	0.9 - 5.2	9.8 - 58.8	700 - 1600	1 1/4"	1/4" F/Hex
BF080 ESD	Lever Start	145793	0.9 - 6.9	9.8 - 78.4	450 - 1000	1 1/4"	1/4" F/Hex
BF080P ESD	Push-to-Start	145794	0.9 - 6.9	9.8 - 78.4	450 - 1000	1 1/4"	1/4" F/Hex
BF120 ESD	Lever Start	145776	1.7 - 10.4	19.6 - 117.6	300 - 700	1 1/4"	1/4" F/Hex
BF120P ESD	Push-to-Start	145795	1.7 - 10.4	19.6 - 117.6	300 - 700	1 1/4"	1/4" F/Hex

### Related Products



**Transformer (Power Supply)**  
Requires transformer to operate.

**STC40 Transformer**  
Item # 145754



**Program Lock Key**  
Item # 145774

To adjust RPM & soft start settings the Program Lock Key must be plugged into the STC40 Transformer.



**Torque Cover**  
Protects from incidental or operator tampering of torque setting.

**Item # 145611**  
For: BF-Series models



**Screw Counter**  
Eliminate costly screw-fastening errors during the assembly process.

**Scout II (Item # 145790)**

# BF-SERIES BRUSHLESS ELECTRIC SCREWDRIVERS

## (Standard Plus Models)

- Various models that range from 0.9 - 10.4 lbf.in
- Double Hit Mode for soft joint applications and selectable Soft Start mode (from 0.2 - 0.6 seconds). These options are controlled on the side of the driver.
- High-performance Swiss Maxon brushless motors are engineered for higher efficiency and performance. External torque adjustment scale.
- Lower maintenance requirements and expenses. Longer lifespan (no brush and commutator erosion)
- Ensures accuracy in fastening with precision automatic shut-off clutch once preset torque is achieved.
- It can be connected with the Scout Screw Counter. Requires an STC40 transformer (power supply).
- All models are ESD designed and prevent electrostatic discharge, which improves production yields, manufacturing costs, product quality, product reliability, reputation, and profitability.



### Torque Ranges

Models	Driver Type	Item #	lbf.in	cN.m	RPM	Grip Dia	Drive Size
BF060 ESD Plus	Lever Start	145886	0.9 - 5.2	9.8 - 58.8	1600	1 1/4"	1/4" F/Hex
BF060P ESD Plus	Push-to-Start	145887	0.9 - 5.2	9.8 - 58.8	1600	1 1/4"	1/4" F/Hex
BF080 ESD Plus	Lever Start	145798	0.9 - 6.9	9.8 - 78.4	1000	1 1/4"	1/4" F/Hex
BF080P ESD Plus	Push-to-Start	145799	0.9 - 6.9	9.8 - 78.4	1000	1 1/4"	1/4" F/Hex
BF120 ESD Plus	Lever Start	145830	1.7 - 10.4	19.6 - 117.6	700	1 1/4"	1/4" F/Hex
BF120P ESD Plus	Push-to-Start	145831	1.7 - 10.4	19.6 - 117.6	700	1 1/4"	1/4" F/Hex

### Related Products



**EZ-Glider Torque Arms**  
 Providing ergonomic solutions for your assembly line workers lessens fatigue, prevents injuries, and boosts productivity. A torque arm improves employee safety as the torque arm absorbs torque reaction while simplifying the motions available to the tool operator.



**Torque Cover**  
 Protects from incidental or operator tampering of torque setting.

**Item # 145611**  
 For: BF-Series models



**Transformer (Power Supply)**  
 Requires transformer to operate.

**STC40 Transformer**  
**Item # 145754**

# BF-SERIES BRUSHLESS ELECTRIC SCREWDRIVERS

## • (Soft Stop Models)

- Adjustable RPM setting on the tool. A selectable Soft Start mode from 0.2-0.6 seconds.
- Precision “Soft Stop” clutch prevents shock to sensitive assemblies like disk drives, plastics, electronics, etc.
- High-performance Swiss Maxon brushless motors are engineered for higher efficiency and performance. External torque adjustment scale.
- Lower maintenance requirements and expenses. Longer lifespan (no brush and commutator erosion)
- Ensures accuracy in fastening with precision automatic shut-off clutch once preset torque is achieved.
- It can be connected with the Scout Screw Counter. Requires an STC40 transformer (power supply).
- All models are ESD designed and prevent electrostatic discharge, which improves production yields, manufacturing costs, product quality, product reliability, reputation, and profitability.



### Torque Ranges

Models	Driver Type	Item #	lbf.in	cN.m	Adjustable RPM	Grip Dia	Drive Size
BFS060 ESD	Lever Start	145888	0.9 - 5.2	9.8 - 58.8	700 - 1600	1 1/4"	1/4" F/Hex
BFS080 ESD	Lever Start	145833	0.9 - 6.9	9.8 - 78.4	450 - 1000	1 1/4"	1/4" F/Hex
BFS120 ESD	Lever Start	145834	1.7 - 9.1	19.6 - 103	300 - 700	1 1/4"	1/4" F/Hex

## Related Products



**Transformer (Power Supply)**  
Requires transformer to operate.

**STC40 Transformer**  
Item # 145754



**Program Lock Key**  
Item # 145774

To adjust RPM & soft start settings the Program Lock Key must be plugged into the STC40 Transformer.



**Torque Cover**  
Protects from incidental or operator tampering of torque setting.

**Item # 145611**  
For: BF-Series models



**Screw Counter**  
Eliminate costly screw-fastening errors during the assembly process.

**Scout II (Item # 145790)**

# BF-SERIES BRUSHLESS ELECTRIC SCREWDRIVERS

## (Soft Stop Plus Models)

- Various models that range from 0.9 - 9.1 lbf.in
- Double Hit Mode for soft joint applications and selectable Soft Start mode (from 0.2 - 0.6 seconds). These options are controlled on the side of the driver.
- Precision “Soft Stop” clutch prevents shock to sensitive assemblies like disk drives, plastics, electronics, etc.
- High-performance Swiss Maxon brushless motors are engineered for higher efficiency and performance. External torque adjustment scale.
- Lower maintenance requirements and expenses. Longer lifespan (no brush and commutator erosion)
- Ensures accuracy in fastening with precision automatic shut-off clutch once preset torque is achieved.
- It can be connected with the Scout Screw Counter. Requires an STC40 transformer (power supply).
- All models are ESD designed and prevent electrostatic discharge, which improves production yields, manufacturing costs, product quality, product reliability, reputation, and profitability.



### Torque Ranges

Models	Driver Type	Item #	lbf.in	cN.m	RPM	Grip Dia	Drive Size
BFS060 ESD Plus	Lever Start	145889	0.9 - 5.2	9.8 - 58.8	1600	1 1/4"	1/4" F/Hex
BFS080 ESD Plus	Lever Start	145836	0.9 - 6.9	9.8 - 78.4	1000	1 1/4"	1/4" F/Hex
BFS120 ESD Plus	Lever Start	145837	1.7 - 9.1	19.6 - 103	700	1 1/4"	1/4" F/Hex

### Related Products



#### EZ-Glider Torque Arms

Providing ergonomic solutions for your assembly line workers lessens fatigue, prevents injuries, and boosts productivity. A torque arm improves employee safety as the torque arm absorbs torque reaction while simplifying the motions available to the tool operator.



#### Torque Cover

Protects from incidental or operator tampering of torque setting.

**Item # 145611**

For: BF-Series models



#### Transformer (Power Supply)

Requires transformer to operate.

**STC40 Transformer**

**Item # 145754**



# BF-SERIES BRUSHLESS ELECTRIC SCREWDRIVERS

## (Angle Control & Auto Reverse Models)

- Various models that range from 0.9 - 10.4 lbf.in
- Time Angle Control & Auto Reverse model. Set the start and stop point by angle control within a range of 0.25 - 15 turns. Also set the “Stop Holding Time” within a range of 0.1 to 6 seconds.
- Adjustable RPM setting on the tool.
- High-performance Swiss Maxon brushless motors are engineered for higher efficiency and performance. External torque adjustment scale.
- Lower maintenance requirements and expenses. Longer lifespan (no brush and commutator erosion)
- Ensures accuracy in fastening with precision automatic shut-off clutch once preset torque is achieved.
- It can be connected with the Scout Screw Counter. Requires an STC40 transformer (power supply).
- All models are ESD designed and prevent electrostatic discharge, which improves production yields, manufacturing costs, product quality, product reliability, reputation, and profitability.



### Torque Ranges

Models	Driver Type	Item #	lbf.in	cN.m	Adjustable RPM	Grip Dia	Drive Size
BFT060 ESD	Lever Start	145890	0.9 - 5.2	9.8 - 58.8	700 - 1600	1 1/4"	1/4" F/Hex
BFT080 ESD	Lever Start	145839	0.9 - 6.9	9.8 - 78.4	450 - 1000	1 1/4"	1/4" F/Hex
BFT120 ESD	Lever Start	145840	1.7 - 10.4	19.6 - 117.6	300 - 700	1 1/4"	1/4" F/Hex

### Related Products



#### EZ-Glider Torque Arms

Providing ergonomic solutions for your assembly line workers lessens fatigue, prevents injuries, and boosts productivity. A torque arm improves employee safety as the torque arm absorbs torque reaction while simplifying the motions available to the tool operator.



#### Torque Cover

Protects from incidental or operator tampering of torque setting.

#### Item # 145611

For: BF-Series models



#### Transformers (Power Supplies)

Requires transformer to operate,

#### STC40 Transformer

Item # 145754

# BFA-SERIES BRUSHLESS ROBOTIC SCREWDRIVERS

- Various models that range from 0.9 - 10.4 lbf.in
- Robotic style electric screwdriver for automated and fixtured applications.
- Drivers include a front mounting flange. Forward and reverse direction by switch. Start and stop output signals.
- High-performance Swiss Maxon brushless motors are engineered for higher efficiency and performance. External torque adjustment scale.
- Lower maintenance requirements and expenses. Longer lifespan (no brush and commutator erosion)
- Ensures accuracy in fastening with precision automatic shut-off clutch once preset torque is achieved.
- It can be connected with the Scout Screw Counter. Requires an STC40 transformer (power supply).
- All models are ESD designed and prevent electrostatic discharge, which improves production yields, manufacturing costs, product quality, product reliability, reputation, and profitability.



## Torque Ranges

Models	Driver Type	Item #	lbf.in	cN.m	Adjustable RPM	Grip Dia	Drive Size
BFA060 ESD	Robotic	145841	0.9 - 5.2	9.8 - 58.8	700 - 1600	1 1/4"	1/4" F/Hex
BFA080 ESD	Robotic	145842	0.9 - 6.9	9.8 - 78.4	450 - 1000	1 1/4"	1/4" F/Hex
BFA120 ESD	Robotic	145843	1.7 - 10.4	19.6 - 117.6	300 - 700	1 1/4"	1/4" F/Hex

## Related Products



**Transformer (Power Supply)**  
Requires transformer to operate.

**STC40-FA Transformer**  
Item # 145869



**Screw Counter**  
Eliminate costly screw-fastening errors during the assembly process.

**Scout II (Item # 145790)**



### Automation Screw Presenters

The cost-saving device makes the assembly process more efficient by mechanically presenting a screw to a fixed pick-up point. Optimize resources, cut labor costs and increase production capacity with automation equipment. Ideal for robotic manufacturing applications.

# NF-SERIES BRUSHLESS ELECTRIC SCREWDRIVERS

## (Standard Models)

- Various models that range from 2.6 - 39 lbf.in
- Adjustable RPM setting on the tool. A selectable Soft Start mode from 0.2-0.6 seconds.
- High-performance Swiss Maxon brushless motors are engineered for higher efficiency and performance. External torque adjustment scale.
- Lower maintenance requirements and expenses. Longer lifespan (no brush and commutator erosion)
- Ensures accuracy in fastening with precision automatic shut-off clutch once preset torque is achieved.
- It can be connected with the Scout Screw Counter. Requires an STC40 transformer (power supply).
- All models are ESD designed and prevent electrostatic discharge, which improves production yields, manufacturing costs, product quality, product reliability, reputation, and profitability.



### Torque Ranges

Models	Driver Type	Item #	lbf.in	cN.m	Adjustable RPM	Grip Dia	Drive Size
NF150-A ESD	Lever Start	145846	2.6 - 13	29.4 - 147	800 - 1700	1 1/3"	1/4" F/Hex
NF150P-A ESD	Push-to-Start	145849	2.6 - 13	29.4 - 147	800 - 1700	1 1/3"	1/4" F/Hex
NF220-A ESD	Lever Start	145847	5.2 - 19	58.9 - 215.8	600 - 1200	1 1/3"	1/4" F/Hex
NF220P-A ESD	Push-to-Start	145850	5.2 - 19	58.9 - 215.8	600 - 1200	1 1/3"	1/4" F/Hex
NF450-A ESD	Lever Start	145848	6.1 - 39	68.7 - 441	300 - 600	1 1/3"	1/4" F/Hex
NF450P-A ESD	Push-to-Start	145851	6.1 - 39	68.7 - 441	300 - 600	1 1/3"	1/4" F/Hex

### Related Products



**Transformer (Power Supply)**  
Requires transformer to operate.

**STC40 Transformer**  
Item # 145754



**Program Lock Key**  
Item # 145774

To adjust RPM & soft start settings the Program Lock Key must be plugged into the STC40 Transformer.



**Torque Cover**  
Protects from incidental or operator tampering of torque setting.

**Item # 145955**  
For: NF-Series models



**Screw Counter**  
Eliminate costly screw-fastening errors during the assembly process.

**Scout II (Item # 145790)**

# NF-SERIES BRUSHLESS ELECTRIC SCREWDRIVERS

## (Standard Plus Models)

- Various models that range from 2.6 - 39 lbf.in
- Double Hit Mode for soft joint applications and selectable Soft Start mode (from 0.2 - 0.6 seconds). These options are controlled on the side of the driver.
- High-performance Swiss Maxon brushless motors are engineered for higher efficiency and performance. External torque adjustment scale.
- Lower maintenance requirements and expenses. Longer lifespan (no brush and commutator erosion)
- Ensures accuracy in fastening with precision automatic shut-off clutch once preset torque is achieved.
- It can be connected with the Scout Screw Counter. Requires an STC40 transformer (power supply).
- All models are ESD designed and prevent electrostatic discharge, which improves production yields, manufacturing costs, product quality, product reliability, reputation, and profitability.



### Torque Ranges

Models	Driver Type	Item #	lbf.in	cN.m	RPM	Grip Dia	Drive Size
NF150-A ESD Plus	Lever Start	145852	2.6 - 13	29.4 - 147	1700	1 1/3"	1/4" F/Hex
NF150P-A ESD Plus	Push-to-Start	145855	2.6 - 13	29.4 - 147	1200	1 1/3"	1/4" F/Hex
NF220-A ESD Plus	Lever Start	145853	5.2 - 19	58.9 - 215.8	600	1 1/3"	1/4" F/Hex
NF220P-A ESD Plus	Push-to-Start	145856	5.2 - 19	58.9 - 215.8	1700	1 1/3"	1/4" F/Hex
NF450-A ESD Plus	Lever Start	145854	6.1 - 39	68.7 - 441	1200	1 1/3"	1/4" F/Hex
NF450P-A ESD Plus	Push-to-Start	145857	6.1 - 39	68.7 - 441	600	1 1/3"	1/4" F/Hex

### Related Products



#### EZ-Glider Torque Arms

Providing ergonomic solutions for your assembly line workers lessens fatigue, prevents injuries, and boosts productivity. A torque arm improves employee safety as the torque arm absorbs torque reaction while simplifying the motions available to the tool operator.



#### Torque Cover

Protects from incidental or operator tampering of torque setting.

#### Item # 145955

For: NF-Series models



#### Transformer (Power Supply)

Requires transformer to operate.

#### STC40 Transformer

Item # 145754

# NF-SERIES BRUSHLESS ELECTRIC SCREWDRIVERS (Soft Stop Models)

- Various models that range from 2.6 - 39 lbf.in
- Adjustable RPM setting on the tool. A selectable Soft Start mode from 0.2-0.6 seconds.
- Precision “Soft Stop” clutch prevents shock to sensitive assemblies like disk drives, plastics, electronics, etc.
- High-performance Swiss Maxon brushless motors are engineered for higher efficiency and performance. External torque adjustment scale.
- Lower maintenance requirements and expenses. Longer lifespan (no brush and commutator erosion)
- Ensures accuracy in fastening with precision automatic shut-off clutch once preset torque is achieved.
- It can be connected with the Scout Screw Counter. Requires an STC40 transformer (power supply).
- All models are ESD designed and prevent electrostatic discharge, which improves production yields, manufacturing costs, product quality, product reliability, reputation, and profitability.



### Torque Ranges

Models	Driver Type	Item #	lbf.in	cN.m	Adjustable RPM	Grip Dia	Drive Size
NFS150-A ESD	Lever Start	145865	2.6 - 13	29.4 - 147	800 - 1700	1 1/3"	1/4" F/Hex
NFS220-A ESD	Lever Start	145866	5.2 - 19	58.9 - 215.8	600 - 1200	1 1/3"	1/4" F/Hex

### Related Products



**Transformer (Power Supply)**  
Requires transformer to operate.

**STC40 Transformer**  
Item # 145754



**Program Lock Key**  
Item # 145774

To adjust RPM & soft start settings the Program Lock Key must be plugged into the STC40 Transformer.



**Torque Cover**  
Protects from incidental or operator tampering of torque setting.

**Item # 145955**  
For: NF-Series models



**Screw Counter**  
Eliminate costly screw-fastening errors during the assembly process.

**Scout II (Item # 145790)**

## NF-SERIES BRUSHLESS ELECTRIC SCREWDRIVERS (Angle Control & Auto Reverse Models)

- Various models that range from 2.6 - 39 lbf.in
- Time Angle Control & Auto Reverse model. Set the start and stop point by angle control within a range of 0.25 - 15 turns. Also set the "Stop Holding Time" within a range of 0.1 to 6 seconds.
- Adjustable RPM setting on the tool.
- High-performance Swiss Maxon brushless motors are engineered for higher efficiency and performance. External torque adjustment scale.
- Lower maintenance requirements and expenses. Longer lifespan (no brush and commutator erosion)
- Ensures accuracy in fastening with precision automatic shut-off clutch once preset torque is achieved.
- It can be connected with the Scout Screw Counter. Requires an STC40 transformer (power supply).
- All models are ESD designed and prevent electrostatic discharge, which improves production yields, manufacturing costs, product quality, product reliability, reputation, and profitability.



### Torque Ranges

Models	Driver Type	Item #	lbf.in	cN.m	Adjustable RPM	Grip Dia	Drive Size
NFT150-A ESD	Lever Start	145858	2.6 - 13	29.4 - 147	800 - 1700	1 1/3"	1/4" F/Hex
NFT220-A ESD	Lever Start	145859	5.2 - 19	58.9 - 215.8	600 - 1200	1 1/3"	1/4" F/Hex
NFT450-A ESD	Lever Start	145860	6.1 - 39	68.7 - 441	300 - 600	1 1/3"	1/4" F/Hex

### Related Products



#### EZ-Glider Torque Arms

Providing ergonomic solutions for your assembly line workers lessens fatigue, prevents injuries, and boosts productivity. A torque arm improves employee safety as the torque arm absorbs torque reaction while simplifying the motions available to the tool operator.



#### Torque Cover

Protects from incidental or operator tampering of torque setting.

#### Item # 145955

For: NF-Series models



#### Transformer (Power Supply)

Requires transformer to operate.

#### STC40 Transformer

Item # 145754

## NFA-SERIES BRUSHLESS ROBOTIC SCREWDRIVERS

- Various models that range from 2.6 - 39 lbf.in
- Robotic style electric screwdriver for automated and fixtured applications.
- Drivers include a front mounting flange. Forward and reverse direction by switch. Start and stop output signals.
- High-performance Swiss Maxon brushless motors are engineered for higher efficiency and performance. External torque adjustment scale.
- Lower maintenance requirements and expenses. Longer lifespan (no brush and commutator erosion)
- Ensures accuracy in fastening with precision automatic shut-off clutch once preset torque is achieved.
- It can be connected with the Scout Screw Counter. Requires an STC40 transformer (power supply).
- All models are ESD designed and prevent electrostatic discharge, which improves production yields, manufacturing costs, product quality, product reliability, reputation, and profitability.



### Torque Ranges

Models	Driver Type	Item #	lbf.in	cN.m	Adjustable RPM	Grip Dia	Drive Size
NFA150-A ESD	Robotic	145861	2.6 - 13	29.4 - 147	800 - 1700	1 1/3"	1/4" F/Hex
NFA220-A ESD	Robotic	145862	5.2 - 19	58.9 - 215.8	600 - 1200	1 1/3"	1/4" F/Hex
NFA450-A ESD	Robotic	145863	6.1 - 39	68.7 - 441	300 - 600	1 1/3"	1/4" F/Hex

### Related Products



**Transformer (Power Supply)**  
Requires transformer to operate.

**STC40-FA Transformer**  
Item # 145869



**Screw Counter**  
Eliminate costly screw-fastening errors during the assembly process.

**Scout II (Item # 145790)**



#### Automation Screw Presenters

The cost-saving device makes the assembly process more efficient by mechanically presenting a screw to a fixed pick-up point. Optimize resources, cut labor costs and increase production capacity with automation equipment. Ideal for robotic manufacturing applications.

# HF-SERIES BRUSHLESS ELECTRIC SCREWDRIVERS

- Various models that range from 17.4 - 87 lbf.in
- High-performance Swiss Maxon brushless motors are engineered for higher efficiency and performance.
- Lower maintenance requirements and expenses. Longer lifespan (no brush and commutator erosion)
- Ensures accuracy in fastening with precision automatic shut-off clutch once preset torque is achieved.
- External torque adjustment scale.
- Adjustable RPM setting on the tool. A selectable Soft Start mode from 0.2-0.6 seconds.
- It can be connected with the Scout Screw Counter. Requires an HTC35 transformer (power supply).
- All models are ESD designed and prevent electrostatic discharge, which improves production yields, manufacturing costs, product quality, product reliability, reputation, and profitability.



## Torque Ranges

Models	Driver Type	Item #	lbf.in	cN.m	Adjustable RPM	Grip Dia	Drive Size
HF50N-A ESD	Lever Start	145925	17.4 - 43.4	196.2 - 490.5	600 - 1050	1 1/2"	1/4" F/Hex
HF50NP-A ESD	Push-to-Start	145926	17.4 - 43.4	196.2 - 490.5	600 - 1050	1 1/2"	1/4" F/Hex
HF100N-A ESD	Lever Start	145927	34.7 - 87	392.4 - 981	150 - 550	1 1/2"	1/4" F/Hex

## Related Products

**Transformer (Power Supply)**  
Requires transformer to operate.

**HTC35 Plus Transformer**  
Item # 145824

**Program Lock Key**  
Item # 145774

To adjust RPM & soft start settings the Program Lock Key must be plugged into the HTC35 Transformer.



**Torque Cover**  
Protects from incidental or operator tampering of torque setting.

**Item # 145903**  
For: HF-Series models



**Screw Counter**  
Eliminate costly screw-fastening errors during the assembly process.

**Scout II (Item # 145790)**





# LF-SERIES BRUSHLESS ELECTRIC SCREWDRIVERS

- Various models that range from 0.8 - 15.6 lbf.in
- High-performance Swiss Maxon brushless motors are engineered for higher efficiency and performance.
- Lower maintenance requirements and expenses. Longer lifespan (no brush and commutator erosion)
- Ensures accuracy in fastening with precision automatic shut-off clutch once preset torque is achieved.
- External torque adjustment scale.
- Available in Lever and Push-to-Start models.
- It can be connected with the Scout Screw Counter. Requires an STC 40 or FT-30D transformer (power supply).
- All models are ESD designed and prevent electrostatic discharge, which improves production yields, manufacturing costs, product quality, product reliability, reputation, and profitability.



## Torque Ranges

Models	Driver Type	Item #	lbf.in	cN.m	RPM	Grip Dia	Drive Size
LF060-A ESD	Lever Start	145897	0.8 - 5.2	9.8 - 58.8	1550	1 1/2"	1/4" F/Hex
LF060P-A ESD	Push-to-Start	145898	0.8 - 5.2	9.8 - 58.8	1550	1 1/2"	1/4" F/Hex
LF080-A ESD	Lever Start	145891	1.7 - 6.9	19.6 - 78.4	1250	1 1/2"	1/4" F/Hex
LF080P-A ESD	Push-to-Start	145892	1.7 - 6.9	19.6 - 78.4	1250	1 1/2"	1/4" F/Hex
LF120-A ESD	Lever Start	145893	2.6 - 10.4	29.4 - 117.6	1000	1 1/2"	1/4" F/Hex
LF120P-A ESD	Push-to-Start	145894	2.6 - 10.4	29.4 - 117.6	1000	1 1/2"	1/4" F/Hex
LF180-A ESD	Lever Start	145895	3.5 - 15.6	39.3 - 176.6	700	1 1/2"	1/4" F/Hex
LF180P-A ESD	Push-to-Start	145896	3.5 - 15.6	39.3 - 176.6	700	1 1/2"	1/4" F/Hex

## Related Products



### Torque Covers

Protects from incidental or operator tampering of torque setting.

**Item # 145823**

For: LF-Series models



### Transformers (Power Supplies)

Requires transformer to operate.

**STC40 Transformer**

**Item # 145754**



**FT-30D Mini Transformer**

**Item # 145870**

# EF-SERIES ELECTRIC SCREWDRIVERS

- Various models that range from 0.3 - 15.6 lbf.in
- Rugged production tool is designed to increase productivity and enhance product quality through precision torque control and user comfort.
- Ensures accuracy in fastening with precision automatic shut-off clutch once preset torque is achieved.
- External torque adjustment scale.
- Available in Lever and Push-to-Start models.
- It can be connected with the Scout Screw Counter. Requires STC 30 Plus Transformer (power supply). Mini EF-Series models are compatible with both STC 30 Plus and mini ET-30D transformer (power supply).
- All models are ESD designed and prevent electrostatic discharge, which improves production yields, manufacturing costs, product quality, product reliability, reputation, and profitability.



## Torque Ranges

Models	Driver Type	Item #	lbf.in	cN.m	RPM High	RPM Low	Grip Dia	Drive Size
EF030-E ESD	Lever Start	145781	0.3 - 2.6	3 - 29	1000	700	1 1/5"	4mm Hios Dr.
EF040-E ESD	Lever Start	145782	0.35 - 3.5	3.9 - 39	1000	700	1 1/5"	4mm Hios Dr.
EF055-E ESD	Lever Start	145783	0.4 - 4.8	4.9 - 54	1000	500	1 1/5"	4mm Hios Dr.
EF080-A ESD	Lever Start	145704	0.8 - 6.9	9.8 - 78.4	1000	670	1 1/4"	1/4" F/Hex
EF080P-A ESD	Push-to-Start	145705	0.8 - 6.9	9.8 - 78.4	1000	670	1 1/4"	1/4" F/Hex
EF120-A ESD	Lever Start	145708	1.7 - 10.4	19.6 - 117.6	1000	670	1 1/4"	1/4" F/Hex
EF120P-A ESD	Push-to-Start	145709	1.7 - 10.4	19.6 - 117.6	1000	670	1 1/4"	1/4" F/Hex
EF180-A ESD	Lever Start	145880	1.7 - 15.6	19.6 - 176.6	630	440	1 1/4"	1/4" F/Hex
EF180P-A ESD	Push-to-Start	145881	1.7 - 15.6	19.6 - 176.6	630	440	1 1/4"	1/4" F/Hex

## Related Products



### Torque Covers

Protects from incidental or operator tampering of torque setting.

#### Item # 145773

For: (EF030, EF040 & EF050 models only)

#### Item # 145700

For: (EF080, EF120 & EF180 models only)



### Transformers (Power Supplies)

Requires transformer to operate.

#### STC30 Plus Transformer (Item # 145683)

For any EF-Series models



#### ET-30D Mini Transformer (Item # 145899)

For only EF030, EF040 & EF055 models

# K-SERIES ELECTRIC SCREWDRIVERS

- Various models that range from 2.6 - 39 lbf.in
- Rugged production tool is designed to increase productivity and enhance product quality through precision torque control and user comfort.
- Ensures accuracy in fastening with precision automatic shut-off clutch once preset torque is achieved.
- External torque adjustment scale.
- Available in Lever and Push-to-Start models.
- It can be connected with the Scout Screw Counter. Requires STC 30 Plus Transformer (power supply).
- All models are ESD designed and prevent electrostatic discharge, which improves production yields, manufacturing costs, product quality, product reliability, reputation, and profitability.



## Torque Ranges

Models	Driver Type	Item #	lbf.in	cN.m	RPM High	RPM Low	Grip Dia	Drive Size
K250-A ESD	Lever Start	145665	2.6 - 21.7	29.4 - 245	1050	630	1 1/2"	1/4" F/Hex
K250P-A ESD	Push-to-Start	145673	2.6 - 21.7	29.4 - 245	1050	630	1 1/2"	1/4" F/Hex
K350-A ESD	Lever Start	145666	3.5 - 30.4	39.3 - 343	750	460	1 1/2"	1/4" F/Hex
K350P-A ESD	Push-to-Start	145674	3.5 - 30.4	39.3 - 343	750	460	1 1/2"	1/4" F/Hex
K450-A ESD	Lever Start	145667	4.3 - 39	49.1 - 441	550	330	1 1/2"	1/4" F/Hex
K450P-A ESD	Push-to-Start	145675	4.3 - 39	49.1 - 441	550	330	1 1/2"	1/4" F/Hex

## Related Products



**Transformer (Power Supply)**  
Requires transformer to operate.

**STC30 Plus Transformer**  
Item # 145683



**Torque Cover**  
Protects from incidental or operator tampering of torque setting.

**Item # 145615**  
For: K-Series models



**Scout II Screw Counter**  
Item # 145790

Eliminate costly screw-fastening errors during the assembly process. Detects cross-threading, omissions, unfinished rundowns and cycle complete.

# E-SERIES ELECTRIC SCREWDRIVERS

- Various models that range from 0.9 - 21.7 lbf.in.
- Plugs directly into a power outlet. Does not require a separate power supply.
- Automatic power shut off once torque is achieved.
- Crafted to rest comfortably in the operators hand and reduces work fatigue with ergonomic handgrip.
- External torque adjustment scale.
- Push-to-Start and Lever Models available.
- Power cord with a noise filter to reduce electronic noise (EMC).
- Lightweight.



## Torque Ranges

Models	Driver Type	110V Item #	220V Item #	lbf.in	cN.m	RPM	Grip Dia	Drive Size
E180-A	Lever Start	145645	145646	0.9 - 15.6	10 - 176	1000	1 1/2"	1/4" F/Hex
E180-PS	Push-to-Start	145647	----	2.2 - 15.6	25 - 176	1000	1 1/2"	1/4" F/Hex
E250-A	Lever Start	145649	145650	1.3 - 21.7	15 - 245	630	1 1/2"	1/4" F/Hex
E250-PS	Push-to-Start	145651	----	2.2 - 21.7	25 - 245	630	1 1/2"	1/4" F/Hex

## Related Products

- **Torque Covers**  
Protects from incidental or operator tampering of torque setting.



**Color: Black**  
**Item # 145654**  
For: E-Series



**Color: Blue**  
**Item # 145655**  
For: E-Series



**Color: Green**  
**Item # 145656**  
For: E-Series



**Color: Gold**  
**Item # 145657**  
For: E-Series



**Color: Grey**  
**Item # 145658**  
For: E-Series

# BL-SERIES BRUSHLESS ELECTRIC SCREWDRIVERS

- Various models that range from 0.17 - 30 lbf.in
- High Power brushless motor design that provides durability and longer-lasting service life than a brush type electric screwdriver
- Accurate torque control provides precise and controlled fastening with an automatic shut-off clutch
- Minimal heat build-up while operating the tool continuously. External torque adjustment scale
- ESD safe models prevent electrostatic discharge
- Requires a transformer T-45BL or T-70BL (power supply). OPC models are designed to operate with BLOP-STC3 screw counter



## Torque Ranges

Models	Driver Type	Item #	lbf.in	cN.m	RPM High	RPM Low	Grip Dia	Drive Size
BL-2000 ESD	Lever Start	144390	0.17 - 1.7	2 - 20	990	650	1"	4mm Hios Dr.
BL-200 ESD-OPC	Lever Start	144312	0.17 - 1.7	2 - 20	990	650	1"	4mm Hios Dr.
BL-3000	Lever & Push-to-Start	144393	1.7 - 4.8	2 - 55	980	680	1 1/4"	4mm Hios Dr.
BL-3000 ESD	Lever & Push-to-Start	144395	1.7 - 4.8	2 - 55	980	680	1 1/4"	4mm Hios Dr.
BL-3000-OPC	Lever & Push-to-Start	144313	1.7 - 4.8	2 - 55	980	680	1 1/4"	4mm Hios Dr.
BL-5000X	Lever & Push-to-Start	144383	1.7 - 10	20 - 120	900	590	1 1/4"	1/4" F/Hex
BL5000X ESD	Lever & Push-to-Start	144385	1.7 - 10	20 - 120	900	590	1 1/4"	1/4" F/Hex
BL-5000X-OPC	Lever & Push-to-Start	144389	1.7 - 10	20 - 120	900	590	1 1/4"	1/4" F/Hex
BL-7000X	Lever & Push-to-Start	144397	6.1 - 24	70 - 280	960	630	1 1/2"	1/4" F/Hex
BL-7000X ESD	Lever & Push-to-Start	144398	6.1 - 24	70 - 280	960	630	1 1/2"	1/4" F/Hex
BL-7000X-OPC	Lever & Push-to-Start	144376	6.1 - 24	70 - 280	960	630	1 1/2"	1/4" F/Hex
BL-7000X-HT	Lever & Push-to-Start	144399	6.1 - 30	70 - 340	700	500	1 1/2"	1/4" F/Hex
BL-7000X-HT ESD	Lever & Push-to-Start	144309	6.1 - 30	70 - 340	700	500	1 1/2"	1/4" F/Hex

## Related Products

**Transformer (Power Supply)** Requires transformer to operate.



**T-45BL Mini Transformer**  
Item # 144267  
For BL-2000 & BL-5000 models



**T-70BL Transformer**  
Item # 144400  
For BL-2000 to BL-7000 models



**BLOP-STC3 Screw Counter Transformer**  
Item # 144175  
For BL-2000OPC to BL-7000OPC models

# BLG-SERIES BRUSHLESS ELECTRIC SCREWDRIVERS

- Various models that range from 0.9 - 10 lbf.in
- High Power brushless motor design that provides durability and longer-lasting service life than a brush type electric screwdriver
- Accurate torque control provides precise and controlled fastening with an automatic shut-off clutch
- Minimal heat build-up while operating the tool continuously. External torque adjustment scale
- Ensures accuracy in fastening with precision automatic shut-off clutch once preset torque is achieved.
- Requires a transformer T-45BL or T-70BL (power supply). OPC models are designed to operate with BLOP-STC3 screw counter



### Torque Ranges

Models	Driver Type	Item #	lbf.in	cN.m	RPM High	RPM Low	Grip Dia	Drive Size
BLG-4000X	Lever Start	144520	0.9 - 4.8	10 - 55	1000	690	1 1/4"	1/4" F/Hex
BLG-4000X-OPC	Lever Start	144522	0.9 - 4.8	10 - 55	1000	690	1 1/4"	1/4" F/Hex
BLG-5000X	Lever & Push-to-Start	144521	1.7 - 10	20 - 120	1000	690	1 1/2"	1/4" F/Hex
BLG-5000X-OPC	Lever & Push-to-Start	144523	1.7 - 10	20 - 120	1000	690	1 1/2"	1/4" F/Hex

## Related Products

**Transformer (Power Supply)** Requires transformer to operate.



**T-45BL Mini Transformer**  
Item # 144267  
For BLG-4000 & BLG-5000



**T-70BL Transformer**  
Item # 144400  
For BLG-4000 & BLG-5000 models



**BLOP-STC3 Screw Counter Transformer**  
Item # 144175  
For BLG-4000OPC & BLG-5000OPC models



### EZ-Glider Torque Arms

Providing ergonomic solutions for your assembly line workers lessens fatigue, prevents injuries, and boosts productivity. A torque arm improves employee safety as the torque arm absorbs torque reaction while simplifying the motions available to the tool operator.



### Tool Balancers

Provides easy handling for operators that work with tools for long, continuous hours. The balancers allow tools to be positioned over the workstation for comfortable operation with pneumatic or electric power tools.

## BLG-BC1 SERIES BRUSHLESS ELECTRIC SCREWDRIVERS

- Various models that range from 0.9 - 17 lbf.in
- Features a built-in screw counter. No external screw counter is needed.
- Detect and eliminate costly screw-fastening errors.
- Detects cross-threading, omissions, unfinished rundowns and cycle complete.
- Detection of fastening error and buzzer alert.
- Fastener accept and reject lights (Go/No Go).
- Visual assembly fastener count (count up or down), including the total count. Program fastening time.
- High Power brushless motor design that provides durability and longer-lasting service life than a brush type electric screwdriver
- Accurate torque control provides precise and controlled fastening with an automatic shut-off clutch
- Minimal heat build-up while operating the tool continuously. External torque adjustment scale
- Ensures accuracy in fastening with precision automatic shut-off clutch once preset torque is achieved.
- Requires a transformer T-45BL or T-70BL (power supply).



### Torque Ranges

Models	Driver Type	Item #	lbf.in	cN.m	RPM	RPM	Grip Dia	Drive Size
					High	Low		
BLG-4000XBC1	Lever Start	144524	0.9 - 4.8	10 - 55	1000	690	1 1/4"	1/4" F/Hex
BLG-5000XBC1	Lever & Push-to-Start	144525	1.7 - 10	20 - 120	1000	690	1 1/2"	1/4" F/Hex
BLG-5000XBC1-HT	Lever & Push-to-Start	144526	4.3 - 17	50 - 200	1000	690	1 1/2"	1/4" F/Hex

### Related Products

**Transformer (Power Supply)** Requires transformer to operate.



**T-45BL Mini Transformer**  
**Item # 144267**  
 For BLG-4000 & BLG-5000



**T-70BL Transformer**  
**Item # 144400**  
 For BLG-4000 & BLG-5000 models

# CL-SERIES ELECTRIC SCREWDRIVERS

- Various models that range from 0.17 - 43 lbf.in
- The production tool is designed to increase productivity and enhance product quality through precision torque control and user comfort
- Ensures accuracy in fastening with precision automatic shut-off clutch once preset torque is achieved. External torque adjustment scale
- It can be connected with the Scout Screw Counter. Requires a Transformer (power supply)
- ESD models are designed to prevent electrostatic discharge



## Torque Ranges

Models	Driver Type	Item #	lbf.in	cN.m	RPM		Grip Dia	Drive Size
					High	Low		
CL2000	Lever Start	144103	0.17 - 1.7	2 - 20	680	490	1"	4mm Hios Dr.
CL2000-ESD	Lever Start	144097	0.17 - 1.7	2 - 20	680	490	1"	4mm Hios Dr.
CL3000	Lever Start	144106	0.3 - 1.7	3 - 20	1000	670	1 1/4"	4mm Hios Dr.
CL3000-ESD	Lever Start	144098	0.3 - 1.7	3 - 20	1000	670	1 1/4"	4mm Hios Dr.
CL4000	Lever Start	144110	0.9 - 4.8	10 - 55	1000	690	1 1/4"	1/4" F/Hex
CL4000	Lever Start	144111	0.9 - 4.8	10 - 55	1000	690	1 1/4"	4mm Hios Dr.
CL4000PS	Push-to-Start	144108	0.9 - 4.8	10 - 55	1000	690	1 1/2"	1/4" F/Hex
CL4000-ESD	Lever Start	144099	0.9 - 4.8	10 - 55	1000	690	1 1/2"	1/4" F/Hex
CL6500	Lever Start	144121	2.6 - 14	30 - 160	900	600	1 1/2"	1/4" F/Hex
CL6500-ESD	Lever Start	144100	2.6 - 14	30 - 160	900	600	1 1/2"	1/4" F/Hex
CL7000	Lever Start	144126	2.6 - 22	30 - 250	750	500	1 1/2"	1/4" F/Hex
CL7000-ESD	Lever Start	144101	2.6 - 22	30 - 250	750	500	1 1/2"	1/4" F/Hex
CL7000	Lever Start	144182	2.6 - 24	30 - 271	550	500	1 1/2"	1/4" F/Hex
CL9000PS	Push-to-Start	144130	10 - 43	120 - 500	530	-	2"	1/4" F/Hex

## Related Products

### Transformer (Power Supply)

Requires transformer to operate.



**STC-30 Plus**  
Item # 145683

For CL-2000 to CL-7000 models



**CLT-60**  
Item # 144360

For CL-2000 to CL-7000 models



**CLT-80**  
Item # 144279

For CL-9000 model



# VB-SERIES BRUSHLESS ELECTRIC SCREWDRIVERS

- Various models that range from 2.2 - 39 lbf.in
- Plugs directly into a power outlet. Separate power supply not required
- Ensures accuracy in fastening with precision automatic shut-off clutch once preset torque is achieved
- External torque adjustment scale. Includes a torque cover
- The brushless motor is engineered for higher efficiency and performance. Lower maintenance requirements and expenses. Longer lifespan (no brush and commutator erosion)
- 120 VAC, 10 foot power cord



## Torque Ranges

Models	Driver Type	Item	lbf.in	cN.m	RPM	Grip Dia	Drive Size
VB1510	Lever Start	144280	2.2 - 13	25 - 150	970	1 1/2"	1/4" F/Hex
VB1510PS	Push-to-Start	144281	2.2 - 13	25 - 150	970	1 1/2"	1/4" F/Hex
VB1820	Lever Start	144282	3.5 - 16	40- 180	2000	1 1/2"	1/4" F/Hex
VB1820PS	Push-to-Start	144283	3.5 - 16	40- 180	2000	1 1/2"	1/4" F/Hex
VB3012	Lever Start	144284	4.3 - 26	50 - 300	1200	1 1/2"	1/4" F/Hex
VB3012PS	Push-to-Start	144285	4.3 - 26	50 - 300	1200	1 1/2"	1/4" F/Hex
VB4504	Lever Start	144286	8.7 -39	100 - 450	400	1 1/2"	1/4" F/Hex
VB4504PS	Push-to-Start	144287	8.7 -39	100 - 450	400	1 1/2"	1/4" F/Hex

## Related Products



### Hand Support Ring

Reduces strain on the operator. Allows operator to increase downward pressure without slipping. Ideal for Push-to-Start models.

**Item # 144357**

For: VB-Series



### Pistol Grip Attachment

Converts VB into a pistol grip style tool.

**Item #144274**

For VB-Series (Push-to-Start Models)



### Vacuum Pickup

Connects to an electric torque screwdriver. The suction head allows semi-automatic pickup of non-ferrous fasteners.

**Item # 14356**

For: VB-Series



### Right Angle Adapter

For Lever Start models. Ensures perfect results for hard to reach joints.

**Item # 144365**

For VB-Series (Lever Start models)

## STC30 PLUS V4.3 TRANSFORMER (POWER SUPPLY)

- Start and Stop Signal Output (for PLC)
- Selectable output voltage
- Over Heat Protection (OHP) and Over Current Protection (OCP) protects the driver from damage or malfunction
- Temperature Detection powers down the unit and resets automatically when the unit restores to acceptable levels
- Switchable 110 & 230V input voltage. The unit will reset if motor/current is too high
- Start and Stop Signal Output (for PLC)
- Selectable Soft Start (from 0.2 - 0.6 seconds)
- Selectable Double Hit mode for soft joint applications
- Screwdriver lock Signal Input (for PLC)



RoHS

**Model: STC30 Plus v4.3****Item #145683**

Operates with Electric Screwdriver Models:  
A4500 - 5000  
CL2000 - 7000  
EF030 - 180  
K250 - 450

Rated Output: 2.5A

Max. Output: 5A

Fuse: 6.3A

Break: -

Output VDC: 20 / 30 or 30 / 38

Input VAC: 110 / 230

Size (WxDxH): 4 3/8" x 7 1/2" x 2 3/8"

Weight (lbs.): 1.8

**Model: STC30 Plus v4.3****Item #145684**

Operates with Electric Screwdriver Models:  
SS2000 - 7000

### Related Products

**U-3B INTERFACE CONVERTER**

The PLC interface converter provides three types of signals by converting the open collector signal from STC 30 Plusv4.3 and STC 40

**Model: U-3B****Item #145753**

Size (WxDxH): 3" x 2 3/8" x 1"

Weight (oz.): 3.6

**Types of Signals:**

Open Collector by Opto-Coupler (Reversed)

Relay Contact (Normal Close)

Relay Contact (Normal Open)

Opto-Coupler: 12 - 24 V (10mA max)

Relay Contact: 30VDC (1A max)

## ET-30D MINI TRANSFORMER (POWER SUPPLY)

- Over Heat Protection (OHP) and Over Current Protection (OCP) protect the driver from damage or malfunction.
- Temperature Detection powers down the unit and resets automatically when the unit restores to acceptable levels.
- Switchable 110 ~ 230V input voltage. The unit will reset if the motor/current overload is too high.
- The unit can be connected to the Scout (Screw Counter).



**Model: ET-30D**

**Item #145899**

Operates with Electric Screwdriver Models:  
EF030 - EF055

Max. Output: 1A

Output VDC: 30

Input VAC: 110 ~ 230V

Size (WxDxH): 2 3/4" x 5 1/8" x 1 1/2"

Weight (oz.): 8.8

## STC40 TRANSFORMER (POWER SUPPLY)

- Selectable output voltage.
- Over Heat Protection (OHP) and Over Current Protection (OCP) protects the driver from damage or malfunction.
- Temperature Detection powers down the unit and resets automatically when the unit restores to acceptable levels
- Switchable 110 & 230V input voltage. The unit will reset if motor/current overload is too high
- Start and Stop Signal Output (for PLC)
- Screwdriver lock Signal Input (for PLC)
- The unit can be connected to the Scout (Screw Counter)



RoHS

**Model: STC40****Item #145754**

Operates with Electric Screwdriver Models:

BF035 - 120

NF150 - 450

Max. Output: 10A

Output VDC: 30 / 40

Input VAC: 110 / 230V

Size (WxDxH): 4 3/8" x 7 1/2" x 2 3/8"

Weight (lbs.): 1.8

### Program Lock Key

**Item # 145774**

The Program Lock Key protects from incidental or operator tampering of the programmable settings on the side of select BF & NF-Series models\*. To adjust the settings the Program Lock Key must be plugged into the STC40 & FT-30D Mini Transformer.



**Note!** The program lock key is required for the BF and NF-Series Standard models and Soft Stop models. RPM & Soft Start Settings can not be adjusted without it.

The program lock key **can not be used** with LF-Series and the Plus models of BF, NF-Series and Soft Stop models and Angle & Auto Reverse models.

### U-3B INTERFACE CONVERTER

The PLC interface converter provides three types of signals by converting the open collector signal from STC 30 Plusv4.3 and STC 40

**Model: U-3B****Item #145753**

Size (WxDxH): 3" x 2 3/8" x 1"

Weight (oz.): 3.6



#### Types of Signals:

Open Collector by Opto-Coupler (Reversed)  
Relay Contact (Normal Close)  
Relay Contact (Normal Open)

Opto-Coupler: 12 - 24 V (10mA max)

Relay Contact: 30VDC (1A max)

## STC40-FA TRANSFORMER (POWER SUPPLY)

- Selectable output voltage.
- Over Heat Protection (OHP) and Over Current Protection (OCP) protects the driver from damage or malfunction.
- Temperature Detection powers down the unit and resets automatically when the unit restores to acceptable levels
- Switchable 110 & 230V input voltage. The unit will reset if motor/current overload is too high
- Start and Stop Signal Output (for PLC)
- Screwdriver lock Signal Input (for PLC)
- The unit can be connected to the Scout (Screw Counter)

**Model: STC40-FA****Item #145869**

Operates with Electric Screwdriver Models:

BFA035 - 120

NFA150 - 450

Max. Output: 12A

Output VDC: 30 / 40

Input VAC: 110 / 230V

Size (WxDxH): 4 3/8" x 7 1/2" x 2 3/8"

Weight (lbs.): 1.8



RoHS

**U-3B INTERFACE CONVERTER**

The PLC interface converter provides three types of signals by converting the open collector signal from STC 30 Plusv4.3 and STC 40

**Model: U-3B****Item #145753**

Size (WxDxH): 3" x 2 3/8" x 1"

Weight (oz.): 3.6

**Types of Signals:**

Open Collector by Opto-Coupler (Reversed)

Relay Contact (Normal Close)

Relay Contact (Normal Open)

Opto-Coupler: 12 - 24 V (10mA max)

Relay Contact: 30VDC (1A max)

## FT-30D MINI TRANSFORMER (POWER SUPPLY)

- Over Heat Protection (OHP) and Over Current Protection (OCP) protect the driver from damage or malfunction.
- Temperature Detection powers down the unit and resets automatically when the unit restores to acceptable levels.
- Switchable 110 ~ 230V input voltage. The unit will reset if the motor/current overload is too high.
- The unit can be connected to the Scout (Screw Counter).



RoHS

**Model: FT-30D****Item #145780**

Operates with Electric Screwdriver Models:

BF035 - BF035

LF060 - LF180

Max. Output: 1.2A

Output VDC: 30

Input VAC: 110 ~ 230V

Size (WxDxH): 2 3/4" x 5 1/8" x 1 1/2"

Weight (oz.): 8.8

### Program Lock Key

**Item # 145774**

The Program Lock Key protects from incidental or operator tampering of the programmable settings on the side of select BF & NF-Series models\*. To adjust the settings the Program Lock Key must be plugged into the STC40 & FT-30D Mini Transformer.



**Note!** The program lock key is required for the BF and NF-Series Standard models and Soft Stop models. RPM & Soft Start Settings can not be adjusted without it.

The program lock key **can not be used** with LF-Series and the Plus models of BF, NF-Series and Soft Stop models and Angle & Auto Reverse models.

## CLT-60 TRANSFORMER (POWER SUPPLY)

- Operates with select HIOS electric screwdriver models
- Selectable two-speed (high and low)
- Switching power supply 100 - 240V
- Includes mounting brackets

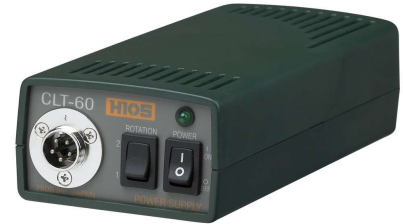

RoHS

**Model: CLT-60****Item #144360**

Operates with Electric Screwdriver Models:

A4500 - 6500

CL2000 - 7000

SS2000 - 7000

Max. Output: 2.5A

Fuse: 5A

Output VDC: 20 / 30

Input VAC: 100 - 240V

Size (WxDxH): 3 1/2" x 8 1/4" x 2"

Weight (lbs.): 1.8

## CLT-80 TRANSFORMER (POWER SUPPLY)

- Operates the HIOS CL-9000 electric screwdriver model
- Switching power supply 100 - 240V
- Includes mounting brackets



RoHS

**Model: CLT-80****Item #144279**

Operates with Electric Screwdriver Model:

CL-9000

Max. Output: 8A

Fuse: 5A

Break: -

Output VDC: 20 / 30

Input VAC: 100 - 240V

Size (WxDxH): 4 1/2" x 8 1/2" x 2"

Weight (lbs.): 3.5

## T-40BL TRANSFORMER (POWER SUPPLY)

- Operates with select BL-Series, BLG-Series and BLG-BC1-Series brushless electric screwdriver models
- Selectable two-speed (high and low)
- Switching power supply 100 - 240V
- Includes mounting brackets



RoHS

**Model: T-45BL****Item #144267**

Operates with Electric Screwdriver Models:

BL2000 - 5000

BLG4000 - 5000

BLG4000XBC1 - 5000XBC1

Max. Output: 1A

Fuse: 2A

Break: 4A

Output VDC: 31

Input VAC: 100 - 240

Size (WxDxH): 2 1/2" x 5 1/4" x 1 1/2"

Weight (oz.): 11.3

## T-70BL TRANSFORMER (POWER SUPPLY)

- Operates with BL-Series, BLG-Series and BLG-BC1-Series brushless electric screwdriver models
- Selectable two-speed (high and low)
- Switching power supply 100 - 240V
- Includes mounting brackets



RoHS

**Model: T-70BL****Item #144400**

Operates with Electric Screwdriver Models:

BL2000 - 7000

BLG4000 - 5000

BLG4000XBC1 - 5000XBC1

Max. Output: 2A

Fuse: 3.15A

Output VDC: 31

Input VAC: 100 - 240

Size (WxDxH): 3 1/2" x 8 1/4" x 2"

Weight (lbs.): 1.5



## CLT-70STC3 SCREW COUNTER TRANSFORMER (POWER SUPPLY)

- Operates with select HIOS electric screwdriver models
- The unit has a built-in screw counter
- Visual assembly fastener count
- Detects - cross-threading, omissions, unfinished rundowns and cycle complete
- A buzzer will sound when the final screw has been tightened to notify you of screw tightening completion
- Outputs for machine & PLC interface for line control
- Switching power supply 100 - 240V



RoHS

**Model: CLT-70STC3****Item #144296**

Operates with Electric Screwdriver Models:

A4500 - 6500

CL2000 - 7000

SS2000 - 7000

Max. Output: 4.5A

Fuse: 3A

Output VDC: 20 / 31

Input VAC: 100 - 240

Size (WxDxH): 5" x 8 1/8" x 3"

Weight (lbs.): 3.5

## BLOP-STC3 SCREW COUNTER TRANSFORMER (POWER SUPPLY)

- Operates with most HIOS BL-Series & BLG-Series electric screwdrivers (OPC models)
- The unit has a built-in screw counter
- Visual assembly fastener count
- Detects - cross-threading, omissions, unfinished rundowns and cycle complete
- A buzzer will sound when the final screw has been tightened to notify you of screw tightening completion
- Outputs for machine & PLC interface for line control
- Switching power supply 100 - 240V



RoHS

**Model: BLOP-STC3****Item #144175**

Operates with Electric Screwdriver Models:

BL2000-OPC to BL7000-OPC

BLG4000-OPC to BLG5000-OPC

Max. Output: 4.5A

Fuse: 3A

Output VDC: 20 / 31

Input VAC: 100 - 240

Size (WxDxH): 5" x 8 1/8" x 3"

Weight (lbs.): 4

**Note!** Only operates with the "OPC" models.

## SCOUT II SCREW COUNTER

- The error-proofing device detects and eliminates costly screw-fastening errors
- Detects cross-threading, omissions, unfinished rundowns and cycle complete
- Detection of fastening error and buzzer alert. Displays error condition
- The fastener accept and reject lights (Go/No Go)
- Visual assembly fastener count (count up or down), including the total count
- Measure and program fastening time
- Ability to store multiple fastener settings with the Parameter mode
- Adjustable parameter settings for the buzzer
- Password protection and wall mountable
- Programming via PC software or through the Scout unit
- Maximum 4 screwdrivers can share one program (4 Ports)
- Outputs for machine & PLC interface for line control
- Input Features: Cycle Start and Driver Lock - prevents driver activation until PLC input signal  
Output Features: Cycle End, OK, NG and Buzzer Alarm



### Scout II

Item # 145790

Dimensions: 5 1/3" x 5 1/3" x 1 1/4" (WxLxH)

Weight: 1 lb.

### Power Supply

Item # 14-GCM6913

**Note!** The Scout can be powered via external power supply (24VDC 1A) or by a transformer model: STC30 Plus, STC40, ET-30D, FT-30D.

### Related Products

The Scout is designed to interface with these transformers: STC30 Plus, STC40, HTC35, ET-30D, FT-30D, YFC-35D.



# XP-SERIES IN-LINE AIR SCREWDRIVERS

- Various models that range from 2.6 - 95.5 lbf.in
- The high-performance oil-free motor delivers environmentally friendly, durable, power and speed. One-third more power than competitive models.
- Safe operation with reduced noise, vibration and low torque reaction.
- High-accuracy patented clutch with precision automatic shut-off.
- Soft texture ergonomic grip for operator comfort.
- One-touch torque adjustment eliminates the difficult setup of drivers.
- Torque nut cover prevents operator tampering.
- Built with aluminum alloy to provide durability and reduced maintenance - no cracking, fading or chipping found in composite body tools.



## Torque Ranges

Models	Driver Type	Item #	lbf.in	N.m	RPM	Grip Dia	Drive Size	Air Usage cfm	Min Air Hose Bore
XP35	Lever Start	360000	2.6 - 17.4	0.3 - 2	2200	1 1/4"	1/4" F/Hex	8.5	5.0 mm
XP35PS	Push-to-Start	360005	2.6 - 17.4	0.3 - 2	2200	1 1/4"	1/4" F/Hex	8.5	5.0 mm
XP40	Lever Start	360001	4.3 - 30.4	0.5 - 3.4	1000	1 1/4"	1/4" F/Hex	8.5	5.0 mm
XP40PS	Push-to-Start	360006	4.3 - 30.4	0.5 - 3.4	1000	1 1/4"	1/4" F/Hex	8.5	5.0 mm
XP45	Lever Start	360002	6.9 - 34.7	0.8 - 3.9	800	1 1/4"	1/4" F/Hex	8.5	5.0 mm
XP45PS	Push-to-Start	360007	6.9 - 34.7	0.8 - 3.9	800	1 1/4"	1/4" F/Hex	8.5	5.0 mm
XP48	Lever Start	360003	4.3 - 39.1	0.5 - 4.4	1700	1 1/2"	1/4" F/Hex	15.9	8.0 min
XP48PS	Push-to-Start	360008	4.3 - 39.1	0.5 - 4.4	1700	1 1/2"	1/4" F/Hex	15.9	8.0 min
XP60	Lever Start	360004	26 - 95.5	2.9 - 10.8	550	1 1/2"	1/4" F/Hex	15.9	8.0 min
XP60PS	Push-to-Start	360009	26 - 95.5	2.9 - 10.8	550	1 1/2"	1/4" F/Hex	15.9	8.0 min

## Related Products



### Filter Regulators

It combines an air filter and air regulator in a single unit. The device removes solid and liquid contaminants from the air while also providing controlled, reliable air pressure.



### Air Hose Reel Balancers

These durable hose reel balancers are designed for small pneumatic tools. Integrating the air hose and support cable helps keep the work area clean.

# XP-SERIES PISTOL GRIP AIR SCREWDRIVERS

- Various models that range from 2.6 - 156.2 lbf.in
- The high-performance oil-free motor delivers environmentally friendly, durable, power and speed. One-third more power than competitive models.
- Safe operation with reduced noise, vibration and low torque reaction.
- High-accuracy patented clutch with precision automatic shut-off.
- Soft texture ergonomic grip for operator comfort.
- One-touch torque adjustment eliminates the difficult setup of drivers.
- Torque nut cover prevents operator tampering.
- Built with aluminum alloy to provide durability and reduced maintenance - no cracking, fading or chipping found in composite body tools.



## Torque Ranges

Models	Item #	lbf.in	N.m	RPM	Grip Dia	Drive Size	Air Usage cfm	Min Air Hose Bore
XP35P	360010	2.6 - 17.4	0.3 - 2	2200	1 1/4"	1/4" F/Hex	9.9	5.0 mm
XP41P	360011	4.3 - 30.4	0.5 - 3.4	1000	1 1/4"	1/4" F/Hex	9.9	5.0 mm
XP48P	360012	6.1 - 43.4	0.8 - 4.9	1700	1 1/2"	1/4" F/Hex	19.4	8.0 min
XP55P	360013	10.4 - 65.1	1.2 - 7.4	1000	1 1/2"	1/4" F/Hex	19.4	8.0 min
XP65P	360014	26 - 156.2	2.9 - 17.6	300	1 1/2"	1/4" F/Hex	19.4	8.0 min

## Related Products



### Filter Regulators

It combines an air filter and air regulator in a single unit. The device removes solid and liquid contaminants from the air while also providing controlled, reliable air pressure.



### Air Hose Reel Balancers

These durable hose reel balancers are designed for small pneumatic tools. Integrating the air hose and support cable helps keep the work area clean.

# XP-SERIES RIGHT ANGLE AIR SCREWDRIVERS

- Various models that range from 2.6 - 95.5 lbf.in
- The high-performance oil-free motor delivers environmentally friendly, durable, power and speed. One-third more power than competitive models.
- Safe operation with reduced noise, vibration and low torque reaction.
- High-accuracy patented clutch with precision automatic shut-off.
- Soft texture ergonomic grip for operator comfort.
- One-touch torque adjustment eliminates the difficult setup of drivers.
- Torque nut cover prevents operator tampering.
- Built with aluminum alloy to provide durability and reduced maintenance - no cracking, fading or chipping found in composite body tools.



## Torque Ranges

Models	Item #	lbf.in	N.m	RPM	Grip Dia	Drive Size	Air Usage cfm	Min Air Hose Bore
XP35A	360015	2.6 - 17.4	0.3 - 2	2200	1 1/4"	1/4" F/Hex	8.5	5.0 mm
XP40A	360016	4.3 - 30.4	0.5 - 3.4	1000	1 1/4"	1/4" F/Hex	8.5	5.0 mm
XP48A	360017	4.3 - 39.1	0.5 - 4.4	1700	1 1/2"	1/4" F/Hex	15.9	8.0 min
XP55A	360018	10.4 - 65.1	1.2 - 7.4	1000	1 1/2"	1/4" F/Hex	15.9	8.0 min
XP60A	360019	26 - 95.5	2.9 - 10.8	550	1 1/2"	1/4" F/Hex	15.9	8.0 min

## Related Products



### Filter Regulators

It combines an air filter and air regulator in a single unit. The device removes solid and liquid contaminants from the air while also providing controlled, reliable air pressure.



### Air Hose Reel Balancers

These durable hose reel balancers are designed for small pneumatic tools. Integrating the air hose and support cable helps keep the work area clean.

# FLEX POWER IN-LINE AUTO SHUT-OFF PULSE TOOLS

- Various models that range from 4.4 - 34.6 lbf.ft
- Ergonomically safer than harmful hammering and vibration of impact wrenches.
- Designed to enhance cycle time with the high-speed rundown.
- Excellent power-to-weight ratio.
- Safe ergonomic tool - low noise decibels, minimal vibration & reaction free operation.
- Comfortable, rubberized non-slip grips for easy handling and excellent thermal ergonomics.
- O-ring design and specially designed pulse fluid FlexPower extends life between regular oil changes and provides more torque stability.
- Specially designed pulse fluid extends life between oil changes and provides better torque stability. Double sealing increases performance and reduces maintenance.
- Automatically shuts off the air supply when the pre-set torque is reached.



## Torque Ranges

Models	Item #	American	S.I.	Free Speed RPM	Drive Size	ft <sup>3</sup> /min cfm	Hose Size
FLEXS-30SX	360122	4.4 - 9.2 lbf.ft	6 - 12.5 N.m	4200	1/4" F/Hex	8.8	1/4"
FLEXS-40SX	360123	7.4 - 13.2 lbf.ft	10 - 18 N.m	4200	1/4" F/Hex	8.7	1/4"
FLEXS-40S	360124	8.1 - 14 lbf.ft	11 - 19 N.m	4200	3/8" Sq. Dr.	8.8	1/4"
FLEXS-50SX	360125	10.3 - 19.1 lbf.ft	14 - 26 N.m	7200	1/4" F/Hex	12.3	1/4"
FLEXS-50S	360126	11.1 - 19.9 lbf.ft	15 - 27 N.m	7200	3/8" Sq. Dr.	12.3	1/4"
FLEXS-60SX	360127	14.8 - 22.1 lbf.ft	20 - 30 N.m	6000	1/4" F/Hex	14.1	3/8"
FLEXS-60S	360128	16.2 - 25.8 lbf.ft	22 - 35 N.m	6000	3/8" Sq. Dr.	14.1	3/8"
FLEXS-70S	360129	22.8 - 34.6 lbf.ft	31 - 47 N.m	5000	3/8" Sq. Dr.	14.1	3/8"

## Related Products



### Filter Regulators

It combines an air filter and air regulator in a single unit. The device removes solid and liquid contaminants from the air while also providing controlled, reliable air pressure.



### EZ-Glider Torque Arms

Providing ergonomic solutions for your assembly line workers lessens fatigue, prevents injuries, and boosts productivity. A torque arm improves employee safety as the torque arm absorbs torque reaction while simplifying the motions available to the tool operator.

# FLEX POWER IN-LINE NON SHUT-OFF PULSE TOOLS

- Various models that range from 4.4 - 34.6 lbf.ft
- Ergonomically safer than harmful hammering and vibration of impact wrenches.
- Designed to enhance cycle time with the high-speed rundown.
- Excellent power-to-weight ratio.
- Safe ergonomic tool - low noise decibels, minimal vibration & reaction free operation.
- Comfortable, rubberized non-slip grips for easy handling and excellent thermal ergonomics.
- O-ring design and specially designed pulse fluid FlexPower extends life between regular oil changes and provides more torque stability.
- Specially designed pulse fluid extends life between oil changes and provides better torque stability. Double sealing increases performance and reduces maintenance.
- The non shut-off pulse tool is ideal option when the operator needs to control the fastening process.



## Torque Ranges

Models	Item #	American	S.I.	Free Speed RPM	Drive Size	ft <sup>3</sup> /min cfm	Hose Size
FLEX-30SX	360130	4.4 - 9.2 lbf.ft	6 - 12.5 N.m	4200	1/4" F/Hex	8.8	1/4"
FLEX-40SX	360131	7.4 - 13.2 lbf.ft	10 - 18 N.m	4200	1/4" F/Hex	8.7	1/4"
FLEX-40S	360132	8.1 - 14 lbf.ft	11 - 19 N.m	4200	3/8" Sq. Dr.	8.8	1/4"
FLEX-50SX	360133	10.3 - 19.1 lbf.ft	14 - 26 N.m	7200	1/4" F/Hex	12.3	1/4"
FLEX-50S	360134	11.1 - 19.9 lbf.ft	15 - 27 N.m	7200	3/8" Sq. Dr.	12.3	1/4"
FLEX-60SX	360135	14.8 - 22.1 lbf.ft	20 - 30 N.m	6000	1/4" F/Hex	14.1	3/8"
FLEX-60S	360136	16.2 - 25.8 lbf.ft	22 - 35 N.m	6000	3/8" Sq. Dr.	14.1	3/8"
FLEX-70S	360137	22.8 - 34.6 lbf.ft	31 - 47 N.m	5000	3/8" Sq. Dr.	14.1	3/8"

## Related Products



### Filter Regulators

It combines an air filter and air regulator in a single unit. The device removes solid and liquid contaminants from the air while also providing controlled, reliable air pressure.



### EZ-Glider Torque Arms

Providing ergonomic solutions for your assembly line workers lessens fatigue, prevents injuries, and boosts productivity. A torque arm improves employee safety as the torque arm absorbs torque reaction while simplifying the motions available to the tool operator.

## FLEX POWER PISTOL GRIP AUTO SHUT-OFF PULSE TOOLS

- Various models that range from 4.4 - 332 lbf.ft
- Ergonomically safer than harmful hammering and vibration of impact wrenches.
- Designed to enhance cycle time with the high-speed rundown.
- Excellent power-to-weight ratio.
- Safe ergonomic tool - low noise decibels, minimal vibration & reaction free operation.
- Comfortable, rubberized non-slip grips for easy handling and excellent thermal ergonomics.
- O-ring design and specially designed pulse fluid FlexPower extends life between regular oil changes and provides more torque stability.
- Specially designed pulse fluid extends life between oil changes and provides better torque stability. Double sealing increases performance and reduces maintenance.
- Automatically shuts off the air supply when the pre-set torque is reached.



### Torque Ranges

Models	Item #	American	S.I.	Free Speed RPM	Drive Size	ft <sup>3</sup> /min cfm	Hose Size
FLEXS-30P	360168	4.4 - 9.2 lbf.ft	6 - 12.5 N.m	4400	3/8" Sq. Dr.	8.8	1/4"
FLEXS-30PX	360100	4.4 - 9.2 lbf.ft	6 - 12.5 N.m	4400	1/4" F/Hex	8.8	1/4"
FLEXS-40PX	360101	7.4 - 13.2 lbf.ft	10 - 18 N.m	4400	1/4" F/Hex	8.8	1/4"
FLEXS-40P	360102	8.1 - 14 lbf.ft	11 - 19 N.m	4400	3/8" Sq. Dr.	8.8	1/4"
FLEXS-50PX	360103	10.3 - 19.1 lbf.ft	14 - 26 N.m	7200	1/4" F/Hex	12.3	1/4"
FLEXS-50P	360104	11.1 - 19.9 lbf.ft	15 - 27 N.m	7200	3/8" Sq. Dr.	12.3	1/4"
FLEXS-60PX	360105	14.8 - 22.1 lbf.ft	20 - 30 N.m	6200	1/4" F/Hex	14.1	3/8"
FLEXS-60P	360106	16.2 - 25.8 lbf.ft	22 - 35 N.m	6200	3/8" Sq. Dr.	14.1	3/8"
FLEXS-65P	360154	21.4 - 32.2 lbf.ft	29 - 45 N.m	4800	3/8" Sq. Dr.	15.2	3/8"
FLEXS-70PX	360166	22.8 - 34.6 lbf.ft	31 - 47 N.m	7200	1/4" F/Hex	15.9	3/8"
FLEXS-70P	360155	25.8 - 39.8 lbf.ft	35 - 54 N.m	5400	3/8" Sq. Dr.	15.9	3/8"
FLEXS-80P	360156	35.4 - 50.1 lbf.ft	48 - 68 N.m	5400	3/8" Sq. Dr.	17.6	3/8"
FLEXS-90P	360108	47.2 - 66.4 lbf.ft	64 - 90 N.m	5400	1/2" Sq. Dr.	18.7	3/8"
FLEXS-100P	360109	62.7 - 88.5 lbf.ft	85 - 120 N.m	5300	1/2" Sq. Dr.	19.4	3/8"
FLEXS-130P	360110	90.7 - 109.2 lbf.ft	123 - 148 N.m	3600	1/2" Sq. Dr.	25.6	1/2"
FLEXS-150P	360152	121.7 - 154.9 lbf.ft	165 - 210 N.m	3600	3/4" Sq. Dr.	25.6	1/2"
FLEXS-180P	360157	132.8 - 188 lbf.ft	180 - 255 N.m	2700	3/4" Sq. Dr.	25.6	1/2"
FLEXS-200P	360171	177 - 332 lbf.ft	240 - 450 N.m	3000	3/4" Sq. Dr.	48.78	3/4"



## FLEX POWER PISTOL GRIP NON SHUT-OFF PULSE TOOLS

- Various models that range from 4.4 - 332 lbf.ft
- Ergonomically safer than harmful hammering and vibration of impact wrenches.
- Designed to enhance cycle time with the high-speed rundown.
- Excellent power-to-weight ratio.
- Safe ergonomic tool - low noise decibels, minimal vibration & reaction free operation.
- Comfortable, rubberized non-slip grips for easy handling and excellent thermal ergonomics.
- O-ring design and specially designed pulse fluid FlexPower extends life between regular oil changes and provides more torque stability.
- Specially designed pulse fluid extends life between oil changes and provides better torque stability. Double sealing increases performance and reduces maintenance.
- The non shut-off pulse tool is ideal option when the operator needs to control the fastening process.



### Torque Ranges

Models	Item #	American	S.I.	Free Speed RPM	Drive Size	ft <sup>3</sup> /min cfm	Hose Size
FLEX-30P	360169	4.4 - 9.2 lbf.ft	6 - 12.5 N.m	4400	3/8" Sq. Dr.	8.8	1/4"
FLEX-30PX	360111	4.4 - 9.2 lbf.ft	6 - 12.5 N.m	4400	1/4" F/Hex	8.8	1/4"
FLEX-40PX	360112	7.4 - 13.2 lbf.ft	10 - 18 N.m	4400	1/4" F/Hex	8.8	1/4"
FLEX-40P	360113	8.1 - 14 lbf.ft	11 - 19 N.m	4400	3/8" Sq. Dr.	8.8	1/4"
FLEX-50PX	360114	10.3 - 19.1 lbf.ft	14 - 26 N.m	7200	1/4" F/Hex	12.3	1/4"
FLEX-50P	360115	11.1 - 19.9 lbf.ft	15 - 27 N.m	7200	3/8" Sq. Dr.	12.3	1/4"
FLEX-60PX	360116	14.8 - 22.1 lbf.ft	20 - 30 N.m	6200	1/4" F/Hex	14.1	3/8"
FLEX-60P	360117	16.2 - 25.8 lbf.ft	22 - 35 N.m	6200	3/8" Sq. Dr.	14.1	3/8"
FLEX-65P	360158	21.4 - 32.2 lbf.ft	29 - 45 N.m	4800	3/8" Sq. Dr.	15.2	3/8"
FLEX-70PX	360167	22.8 - 34.6 lbf.ft	31 - 47 N.m	7200	1/4" F/Hex	15.9	3/8"
FLEX-70P	360159	25.8 - 39.8 lbf.ft	35 - 54 N.m	5400	3/8" Sq. Dr.	15.9	3/8"
FLEX-80P	360160	35.4 - 50.1 lbf.ft	48 - 68 N.m	5400	3/8" Sq. Dr.	17.6	3/8"
FLEX-90P	360119	47.2 - 66.4 lbf.ft	64 - 90 N.m	5400	1/2" Sq. Dr.	18.7	3/8"
FLEX-100P	360120	62.7 - 88.5 lbf.ft	85 - 120 N.m	5300	1/2" Sq. Dr.	19.4	3/8"
FLEX-130P	360121	90.7 - 109.2 lbf.ft	123 - 148 N.m	3600	1/2" Sq. Dr.	25.6	1/2"
FLEX-150P	360153	121.7 - 154.9 lbf.ft	165 - 210 N.m	3600	3/4" Sq. Dr.	25.6	1/2"
FLEX-180P	360161	132.8 - 188 lbf.ft	180 - 255 N.m	2700	3/4" Sq. Dr.	25.6	1/2"
FLEX-200P	360172	177 - 332 lbf.ft	240 - 450 N.m	3000	3/4" Sq. Dr.	48.78	3/4"

## FLEX POWER RIGHT ANGLE AUTO SHUT-OFF PULSE TOOLS

- Various models that range from 7 - 51.6 lbf.ft
- Ergonomically safer than harmful hammering and vibration of impact wrenches.
- Designed to enhance cycle time with the high-speed rundown.
- Excellent power-to-weight ratio.
- Safe ergonomic tool - low noise decibels, minimal vibration & reaction free operation.
- Comfortable, rubberized non-slip grips for easy handling and excellent thermal ergonomics.
- O-ring design and specially designed pulse fluid FlexPower extends life between regular oil changes and provides more torque stability.
- Specially designed pulse fluid extends life between oil changes and provides better torque stability. Double sealing increases performance and reduces maintenance.
- Automatically shuts off the air supply when the pre-set torque is reached.



### Torque Ranges

Models	Item #	American	S.I.	Free Speed RPM	Drive Size	ft <sup>3</sup> /min cfm	Hose Size
FLEXS-50RX	360145	7 - 11.8 lbf.ft	9 - 16 N.m	4300	1/4" F/Hex	11.3	1/4"
FLEXS-50R	360138	7.7 - 12.8 lbf.ft	10.5 - 17 N.m	4300	3/8" Sq. Dr.	11.3	1/4"
FLEXS-60RX	360146	10 - 16.2 lbf.ft	13.5 - 22 N.m	5300	1/4" F/Hex	14.1	3/8"
FLEXS-60R	360139	11.1 - 17.7 lbf.ft	15 - 24 N.m	5300	3/8" Sq. Dr.	14.1	3/8"
FLEXS-70RX	360147	14.8 - 21.4 lbf.ft	20 - 29 N.m	4500	1/4" F/Hex	14.1	3/8"
FLEXS-70R	360140	16.2 - 22.8 lbf.ft	22 - 31 N.m	4500	3/8" Sq. Dr.	14.1	3/8"
FLEXS-70RG	360162	27.3 - 36.9 lbf.ft	37 - 50 N.m	2000	3/8" Sq. Dr.	14.1	3/8"
FLEXS-70RH	360144	34 - 44.2 lbf.ft	46 - 60 N.m	2200	1/2" Sq. Dr.	14.1	3/8"
FLEXS-80RH	360163	36.9 - 51.6 lbf.ft	50 - 70 N.m	2800	1/2" Sq. Dr.	15.9	3/8"

### Related Products



#### Filter Regulators

It combines an air filter and air regulator in a single unit. The device removes solid and liquid contaminants from the air while also providing controlled, reliable air pressure.

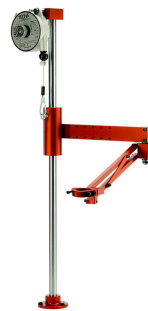

#### EZ-Glider Torque Arms

Providing ergonomic solutions for your assembly line workers lessens fatigue, prevents injuries, and boosts productivity. A torque arm improves employee safety as the torque arm absorbs torque reaction while simplifying the motions available to the tool operator.

## FLEX POWER RIGHT ANGLE NON SHUT-OFF PULSE TOOLS

- Various models that range from 7 - 51.6 lbf.ft
- Ergonomically safer than harmful hammering and vibration of impact wrenches.
- Designed to enhance cycle time with the high-speed rundown.
- Excellent power-to-weight ratio.
- Safe ergonomic tool - low noise decibels, minimal vibration & reaction free operation.
- Comfortable, rubberized non-slip grips for easy handling and excellent thermal ergonomics.
- O-ring design and specially designed pulse fluid FlexPower extends life between regular oil changes and provides more torque stability.
- Specially designed pulse fluid extends life between oil changes and provides better torque stability. Double sealing increases performance and reduces maintenance.
- The non shut-off pulse tool is ideal option when the operator needs to control the fastening process.



### Torque Ranges

Models	Item #	American	S.I.	Free Speed RPM	Drive Size	ft <sup>3</sup> /min cfm	Hose Size
FLEX-50RX	360148	7 - 11.8 lbf.ft	9 - 16 N.m	4300	1/4" F/Hex	11.3	1/4"
FLEX-50R	360141	7.7 - 12.8 lbf.ft	10.5 - 17 N.m	4300	3/8" Sq. Dr.	11.3	1/4"
FLEX-60RX	360149	10 - 16.2 lbf.ft	13.5 - 22 N.m	5300	1/4" F/Hex	14.1	3/8"
FLEX-60R	360142	11.1 - 17.7 lbf.ft	15 - 24 N.m	5300	3/8" Sq. Dr.	14.1	3/8"
FLEX-70RX	360150	14.8 - 21.4 lbf.ft	20 - 29 N.m	4500	1/4" F/Hex	14.1	3/8"
FLEX-70R	360143	16.2 - 22.8 lbf.ft	22 - 31 N.m	4500	3/8" Sq. Dr.	14.1	3/8"
FLEX-70RG	360164	27.3 - 36.9 lbf.ft	37 - 50 N.m	2000	3/8" Sq. Dr.	14.1	3/8"
FLEX-70RH	360151	34 - 44.2 lbf.ft	46 - 60 N.m	2200	1/2" Sq. Dr.	14.1	3/8"
FLEX-80RH	360165	36.9 - 51.6 lbf.ft	50 - 70 N.m	2800	1/2" Sq. Dr.	15.9	3/8"

### Related Products



#### Filter Regulators

It combines an air filter and air regulator in a single unit. The device removes solid and liquid contaminants from the air while also providing controlled, reliable air pressure.



#### EZ-Glider Torque Arms

Providing ergonomic solutions for your assembly line workers lessens fatigue, prevents injuries, and boosts productivity. A torque arm improves employee safety as the torque arm absorbs torque reaction while simplifying the motions available to the tool operator.

# ZERO GRAVITY TOOL BALANCERS

- Provides true balance and easy handling for operators that work with tools for long, continuous hours. The balancers allow tools to be positioned over the workstation for comfortable operation with pneumatic, electric, hydraulic or other power tools.
- Compact & robust
- Easy external tensioning adjustment
- 360 degree top swivel
- No tension build-up to cause worker fatigue
- Aircraft stranded steel cable
- Provision for safety cable
- Permanent lubrication (for MZ-6 through MZ-264 models)
- Safety lock (for MZ-33 through MZ-264 models)



## Balancer Weight Capacity

Models	Item #	Stroke in	Stroke meters	lbs	kg	Weight lbs
MZ-3A	180500	19"	0.5	1.1 - 3.3	0.5 - 1.5	0.5
MZ-3B	180501	39"	1	1.1 - 3.3	0.5 - 1.5	1.1
MZ-6	180502	51"	1.3	2.2 - 6.6	1 - 3	3
MZ-11	180503	51"	1.3	5.5 - 11	2.5 - 5	3.3
MZ-20	180504	51"	1.3	10 - 20	4.5 - 9	7.5
MZ-33	180505	51"	1.3	19.8 - 33	9 - 15	8.4
MZ-48	180506	59"	1.5	33 - 48.4	15 - 22	15.9
MZ-66	180507	59"	1.5	48 - 66	22 - 30	16.8
MZ-88	180508	59"	1.5	66 - 88	30 - 40	21.6
MZ-110	180509	59"	1.5	88 - 110	40 - 50	23
MZ-132	180510	59"	1.5	110 - 132	50 - 60	25.6
MZ-154	180511	59"	1.5	132 - 154	60 - 70	26
MZ-198	180532	82"	2.1	154 - 198	70 - 90	59.5
MZ-231	180533	82"	2.1	187 - 231	85 - 105	63.9
MZ-264	180534	82"	2.1	220 - 264	100 - 200	66.1

# RETRACTOR TOOL BALANCERS

- Provides easy handling for operators that work with tools for long, continuous hours. The balancers allow tools to be positioned over the workstation for comfortable operation with pneumatic, electric, hydraulic or other power tools.
- Lightweight compact
- Easy to adjust the tension with the adjustment knob on the side
- Adjustable cable stop
- 360 degree top swivel
- Provision for safety cable



### Balancer Weight Capacity

Models	Item #	Stroke in	Stroke meters	lbs	kg	Weight lbs
MJ-3	180521	59"	1.5	1.1 - 3.3	0.5 - 1.5	0.7
MR-3	180515	79"	2	1.1 - 3.3	0.5 - 1.5	1.1
MR-6	180516	79"	2	2.2 - 6.6	1 - 3	1.5
MR-11	180517	79"	2	5.5 - 11	2.5 - 5	2

## Related Products



**EZ-Glider Telescoping Torque Arms**  
 Providing ergonomic solutions for your assembly line workers lessens fatigue, prevents injuries, and boosts productivity. A torque arm improves employee safety as the torque arm absorbs torque reaction while simplifying the motions available to the tool operator. These arms require a tool balancer.



**Electric Screwdrivers**  
 Electric torque screwdrivers increase productivity and enhance product quality through precision torque control and user comfort. The electric screwdriver automatically shuts off once the preset torque is achieved.

# AIR HOSE REEL TOOL BALANCERS

- Provides easy handling for operators that work with tools for long, continuous hours. The balancers allow tools to be positioned over the workstation for comfortable operation with pneumatic, electric, hydraulic or other power tools.
- Air tool balancer (hose reel) for small pneumatic tools
- Integrating air hose support cable keeps the work area clean
- Easy to adjust the tension by using the handle
- Provision for safety cable
- Hose diameter (inner/outer) 6.5mm/10mm
- 1/4" NPT connector



## Balancer Weight Capacity

Models	Item #	Stroke in	Stroke meters	Balancer Weight Capacity		Weight lbs
				lbs	kg	
MH-3	180512	51"	1.3	1.1 - 3.3	0.5 - 1.5	1.1
MH-6	180513	51"	1.3	2.2 - 6.6	1 - 3	2.2
MH-11	180514	51"	1.3	5.5 - 11	2.5 - 5	2.9

## Related Products



### EZ-Glider Telescoping Torque Arms

Providing ergonomic solutions for your assembly line workers lessens fatigue, prevents injuries, and boosts productivity. A torque arm improves employee safety as the torque arm absorbs torque reaction while simplifying the motions available to the tool operator. These arms require a tool balancer.



### Air Screwdrivers

Air torque screwdrivers increase productivity and enhance product quality through precision torque control and user comfort. The air screwdriver automatically shuts off once the preset torque is achieved.

# TOOL POSITIONER TOOL BALANCERS

- Provides easy handling for operators that work with tools for long, continuous hours. The balancers allow tools to be positioned over a work area for comfortable operation. The tool will remain at whatever level or position that it is left at.
- Lightweight compact
- Suspends tools for easy access and availability
- Improves production efficiency and reduces worker fatigue



### Balancer Weight Capacity

Model	Item #	Stroke in	Stroke meters	lbs	kg	Weight lbs
Mini 31	180029	60"	1.5	1 - 12	0.4 - 5.6	0.75

## Related Products



### EZ-Glider Telescoping Torque Arms

Providing ergonomic solutions for your assembly line workers lessens fatigue, prevents injuries, and boosts productivity. A torque arm improves employee safety as the torque arm absorbs torque reaction while simplifying the motions available to the tool operator. These arms require a tool balancer.



### Electric Screwdrivers

Electric torque screwdrivers increase productivity and enhance product quality through precision torque control and user comfort. The electric screwdriver automatically shuts off once the preset torque is achieved.

# EZ-GLIDER LINEAR TORQUE ARM

- Providing ergonomic solutions for your assembly line workers lessens fatigue, prevents injuries, and boosts productivity.
- Maneuvers smoothly as the ergonomic torque arm absorbs the torque reaction emitted from power tools
- Reduces RMI (Repetitive Motion Injury) and CTS (Carpal Tunnel Syndrome) while boosting production.
- Prevents cross threading and sideload — keeps tool perpendicular.
- It extends in a horizontal direction and arm length is adjustable.

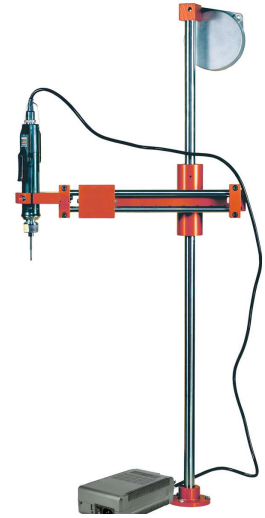

Models	Item #	Max. Torque American	Max Torque S.I.	Clamp Dia.	Height	Min Arm Reach	Max Arm Reach	Balancer Cap. (lbs)
EZ-12	260077	8.8 lbf.ft	12 N.m	1 - 1 1/2"	32 1/2"	16 1/2"	22"	1.1 - 2.6
EZ-25	260078	18.4 lbf.ft	25 N.m	1 - 2"	36 1/2"	16 1/3"	22"	2.2 - 4.8
EZ-40	260079	29.5 lbf.ft	40 N.m	1 - 2"	40 1/2"	21 7/8"	29 1/2"	3.1 - 4.8
EZ-100	260080	73.7 lbf.ft	100 N.m	1 - 2"	40 1/2"	25 1/3"	33"	4.4 - 7.7

## Accessories

-  **Anti-Rotating Clamp**  
Attach an "Anti-Rotating Clamp" to prevent the arm from rotating side-to-side to help the operator target the screw quickly and precisely.

for EZ-12 & 25 Linear Arms  
Item #260019

for EZ-40 & 100 Linear Arms  
Item #260022

**ARP System** A recoil spring positioned on the slide to permits the arm to come back to the rest position as soon as you release it.

for EZ-12 Linear Arm  
Item #260096

for EZ-25 & 40 Linear Arms  
Item #260097



Models	Item #	Extends Max Arm Reach
EZ-12	260088	27.5"
EZ-25	260089	27.5"
EZ-40	260090	36"
EZ-100	260091	41"

**Extension Slides**  
Expands the maximum arm reach of the EZ-Glider Linear Arms.



Models	Item #	Extends Max Arm Reach
EZ-12	260088	27.5"
EZ-25	260089	27.5"
EZ-40	260090	36"
EZ-100	260091	41"

**Extension Double Slides**  
Expands the maximum arm reach of the EZ-Glider Linear Arms.





# EZ-GLIDER ARTICULATED TORQUE ARM

- Providing ergonomic solutions for your assembly line workers lessens fatigue, prevents injuries, and boosts productivity.
- Maneuvers smoothly as the ergonomic torque arm absorbs the torque reaction emitted from power tools
- Reduces RMI (Repetitive Motion Injury) and CTS (Carpal Tunnel Syndrome) while boosting production.
- Prevents cross threading and sideload — keeps tool perpendicular.
- With the ability to bend like an elbow, the torque arm provides agility to position the tool in a variety of positions for different applications. Arm can be set at an inclination of 0°, 22.5° & 45°.



## Min and Max Arm Reach at Inclination

Models	Item #	Max. Torque American	Max Torque S.I.	Clamp Dia.	0°	22.5°	45°	Balancer Cap. (lbs)
EZ-12R	260081	8.8 lbf.ft	12 N.m	1 - 1 1/2"	15 1/8" - 21"	14 1/2" - 20"	12 1/3" - 18"	1.1 - 2.6
EZ-25R	260082	18.4 lbf.ft	25 N.m	1 - 2"	15 1/8" - 21"	15" - 20 1/2"	12 7/8" - 18 1/2"	2.2 - 4.8
EZ-40R	260083	29.5 lbf.ft	40 N.m	1 - 2"	22 1/4" - 30"	21 1/8" - 29"	18 1/8" - 26"	3.1 - 4.8
EZ-100R	260084	73.7 lbf.ft	100 N.m	1 - 2"	26 1/3" - 34"	25 1/8" - 33"	22" - 29 1/2"	4.4 - 7.7

## Accessories

An in-line driver clamp is included with the torque arm. Other clamp options are available and sold separately.

Rotating Clamp



Pistol Grip Clamp



Angle Driver Clamp



Nipple Clamp

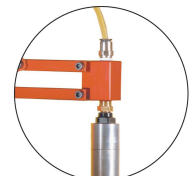

### for EZ-12R

Models	Clamp Dia.	Item #
Rotating Clamp	1 - 1 1/2"	260027
Pistol Grip Clamp	1 - 1 1/2"	260008
Angle Driver Clamp	1 - 1 1/2"	260028
Nipple Clamp	*	260007

### for EZ-25R & 40R

Clamp Dia.	Item #
1 - 2"	260030
1 - 2"	260031
1 - 2"	260032
-	-

### for EZ-100R

Clamp Dia.	Item #
-	-
-	-
1 - 2"	260061
-	-

# EZ-GLIDER TELESCOPING TORQUE ARM

- Ergonomic torque arms absorb the torque reaction emitted from power tools.
- The lightweight, durable carbon fiber the arm collapses like a telescope.
- Easy-to-use requires little space and doesn't disrupt production flow.
- Recommend using a tool balancer with a telescoping arm.
- A balancing kit can be mounted on the side of any telescoping torque arm. It allows the arm to be used with pistol grip tools and angle nutrunners.
- The effortless handling of the torque arm provides comfortable tool operation and increases production.
- Mountable and easy to install on a wall, workbench, and a standard rail or trolley system.
- Maintenance-free.
- It can be used with various assembly tools like electric & pneumatic screwdrivers, nutrunners, pistol style tools, grinders, impact wrenches, drills, sanders, and percussion tools.
- Perfect for MVI applications.
- Universal adapter included.



Models	Item #	Max. Torque American	Max Torque S.I.	Clamp Dia.	Min Arm Reach	Max Arm Reach
EZ-12T	260075	8.8 lbf.ft	12 N.m	1 - 1 1/2"	18.1"	37"
EZ-12T/1500	260115	8.8 lbf.ft	12 N.m	1 - 1 1/2"	25.6"	59"
EZ-12T/2000	260116	8.8 lbf.ft	12 N.m	1 - 1 1/2"	32.3"	78.7"
EZ-30T	260076	22.1 lbf.ft	30 N.m	1 - 2"	18.7"	37.5"
EZ-30T/1500	260117	22.1 lbf.ft	30 N.m	1 - 2"	25.8"	59"
EZ-30T/2000	260118	22.1 lbf.ft	30 N.m	1 - 2"	32.4"	78.7"
EZ-30T/2500	260119	22.1 lbf.ft	30 N.m	1 - 2"	39.1"	98.4"



**Note!** It is recommended to use a tool balancer with all EZ-Glider Telescoping Arm models. Tool balancer is not included with torque arm.

The telescoping arms should not be used at maximum arm reach on a permanent basis.

## EZ-Glider Telescoping Arm Tool Positioning Options:

Standard Tool Balancer needs to be mounted above an in-line tool.

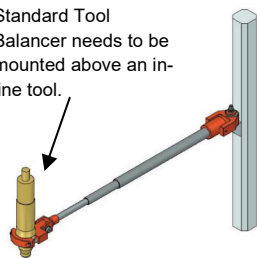

Besides the standard in-line tool mounting position, the telescoping arm can be used with assembly tools in a variety of positions. For some tool positioning options, different tool clamp needs to be ordered separately. Balancing Kit not included with torque arm.

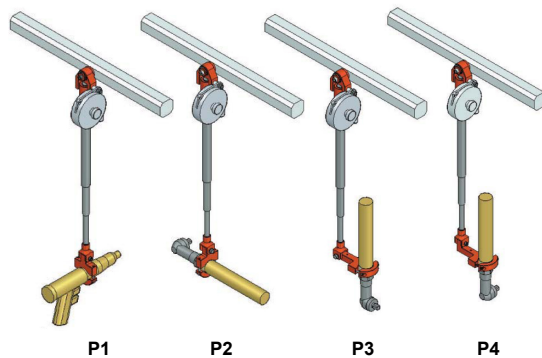

Models	Item #	P1	P2	P3	P4
EZ-12T	260075	Yes	No	No	No
EZ-12T/1500	260115	Yes	No	No	No
EZ-12T/2000	260116	Yes	No	No	No
EZ-30T	260076	Yes	Yes, Order Clamp #260144	Yes, Order Clamp #260145	Yes, Order Clamp #260146
EZ-30T/1500	260117	Yes	Yes, Order Clamp #260144	Yes, Order Clamp #260145	Yes, Order Clamp #260146
EZ-30T/2000	260118	Yes	Yes, Order Clamp #260144	Yes, Order Clamp #260145	Yes, Order Clamp #260146
EZ-30T/2500	260119	Yes	Yes, Order Clamp #260144	Yes, Order Clamp #260145	Yes, Order Clamp #260146

## EZ-Glider Telescoping Arm Accessories

### Standard Gliding Rail System

The Telescoping Torque Arms can be mounted to the Standard Gliding Rail System (sold separately) and can be used in a variety of positions. For a vertical position it is necessary to install one additional item, an interface bracket (sold separately).

Working Distance	Item #
450 mm	260103
650 mm	260104
850 mm	260105
1050 mm	260106
1350 mm	260107
1850 mm	260108

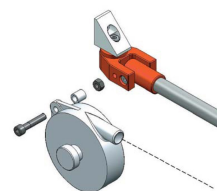

### Balancing Kits for Vertical Mounting

For EZ-12T, 30T models

A balancing kit can be mounted on the side of any telescoping arm. It allows the arm to be used with pistol grip tools and angle nutrunners (see tool position options above)

Item #	Balancer Capacity	Stroke
260140	2.2 - 4.4 lbs.	63"
260141	2.2 - 5.5 lbs.	78.75"
260142	4.4 - 8.8 lbs.	78.75"
260143	8.8 - 13.2 lbs.	78.75"

### Interface Bracket

Item # 260051

For a EZ-30T models mounted to the Standard Gliding Rail system.

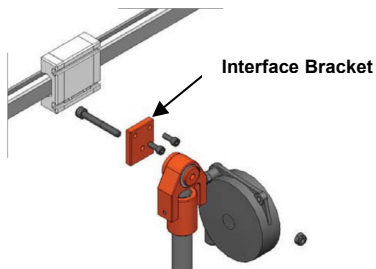

# EZ-GLIDER INVERTED TELESCOPING TORQUE ARM

- Ergonomic torque arms absorb the torque reaction emitted from power tools.
- The lightweight, durable carbon fiber the arm collapses like a telescope.
- Easy-to-use requires little space and doesn't disrupt production flow.
- Recommend using a tool balancer with a telescoping arm.
- A balancing kit can be mounted on the side of any telescoping torque arm. It allows the arm to be used with pistol grip tools and angle nutrunners.
- The effortless handling of the torque arm provides comfortable tool operation and increases production.
- Mountable and easy to install on a wall, workbench, and a standard rail or trolley system.
- Maintenance-free.
- It can be used with various assembly tools like electric & pneumatic screwdrivers, nutrunners, pistol style tools, grinders, impact wrenches, drills, sanders, and percussion tools.
- Perfect for MVI applications.
- Features a reinforced sleeve for long durability with higher torque application.



Models	Item #	Max. Torque American	Max Torque S.I.	Clamp Dia.	Min Arm Reach	Max Arm Reach
EZ-12T	260075	8.8 lbf.ft	12 N.m	1 - 1 1/2"	18.1"	37"
EZ-12T/1500	260115	8.8 lbf.ft	12 N.m	1 - 1 1/2"	25.6"	59"
EZ-12T/2000	260116	8.8 lbf.ft	12 N.m	1 - 1 1/2"	32.3"	78.7"
EZ-30T	260076	22.1 lbf.ft	30 N.m	1 - 2"	18.7"	37.5"
EZ-30T/1500	260117	22.1 lbf.ft	30 N.m	1 - 2"	25.8"	59"
EZ-30T/2000	260118	22.1 lbf.ft	30 N.m	1 - 2"	32.4"	78.7"
EZ-30T/2500	260119	22.1 lbf.ft	30 N.m	1 - 2"	39.1"	98.4"



**Note!** It is recommended to use a tool balancer with all EZ-Glider Inverted Telescoping Arm models. Tool balancer is not included with torque arm.

The telescoping arms should not be used at maximum arm reach on a permanent basis.

## Inverted Telescoping Torque Arm Tool Positioning Options:

The P2 tool position is standard clamp provided with EZ-70IT, EZ-120IT & EZ-200IT. For other tool clamp position options, sold separately.

\*Must provide information (Brand & Model) on each tool being used with the arm. The clamp is custom made to fit the tool being used.

Models	Item #	P1	P3	P4
EZ-70IT/1500	260175	Clamp #260184	Clamp #260185	Clamp #260186
EZ-70IT/2000	260176	Clamp #260184	Clamp #260185	Clamp #260186
EZ-70IT/2500	260177	Clamp #260184	Clamp #260185	Clamp #260186
EZ-120IT/1500	260178	Clamp #260187	Clamp #260188	Clamp #260189
EZ-120IT/2000	260179	Clamp #260187	Clamp #260188	Clamp #260189
EZ-120IT/2500	260180	Clamp #260187	Clamp #260188	Clamp #260189
EZ-200IT/1500	260181	Clamp #260187	*On Request	*On Request
EZ-200IT/2000	260182	Clamp #260187	*On Request	*On Request
EZ-200IT/2500	260183	Clamp #260187	*On Request	*On Request

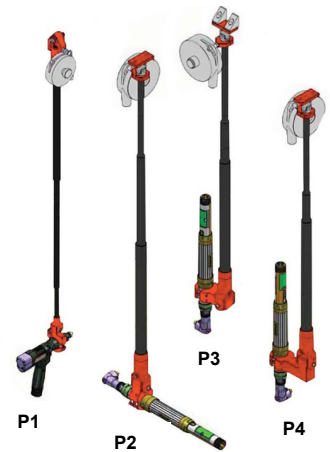

## Inverted Telescoping Torque Arm Accessories

### Standard Gliding Rail System

The Inverted Telescoping Torque Arms can be mounted to the Standard Gliding Rail System (sold separately) and can be used in a variety of positions. For a vertical position it is necessary to install one additional item, an interface bracket (sold separately).

Working Distance	Item #
450 mm	260103
650 mm	260104
850 mm	260105
1050 mm	260106
1350 mm	260107
1850 mm	260108

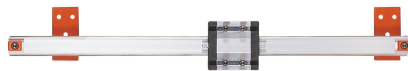

### Balancing Kits for Vertical Mounting

For EZ-70IT, 120IT, & 200IT models

A balancing kit can be mounted on the side of any inverted telescoping arm. It allows the arm to be used with pistol grip tools and angle nutrunners (see tool position options above)

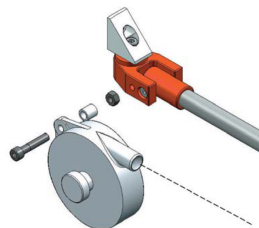

Item #	Balancer Capacity	Stroke
260190	4.4 - 8.8 lbs.	78 3/4"
260191	8.8 - 13.2 lbs.	78 3/4"
260192	13.2 - 17.6 lbs.	78 3/4"

# EZ-GLIDER POSITION CONTROL TORQUE ARM

- Safeguard against fastening failures by ensuring that every screw is in the correct location at the proper torque.
- Programmable sequence operation.
- Traceability and error-proofing. Real-time monitoring.
- Detects - cross-threading, omissions, unfinished rundowns and cycle complete. Keeps tool perpendicular.
- Digital I/O signals for communication with external devices such as PLC.
- Ergonomics and safety for your employees. Reduces RMI (Repetitive Motion Injury) and CTS (Carpal Tunnel Syndrome) while boosting production.
- Provides a smooth, flexible range as the arm absorbs torque reactions from electric air screwdrivers, angle nut runners, pulse tools, and pistol grip tools.
- Quick and easy to set up. Self-teaching and automation program mode.
- Programmable: Positioning tolerance, Min. and Max. time for poka-yoke control (automatic or manual) and 99 memory points
- Compatible with DC Controlled Tools, electric screwdrivers
- Requires DPC-Touch Posi-Control System

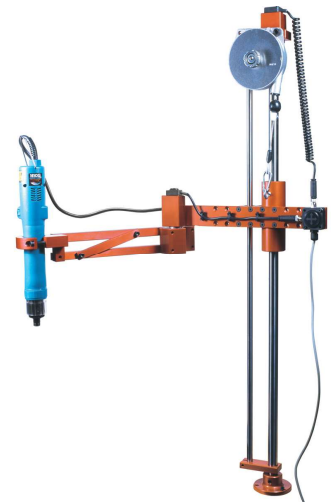

Model	Item #	Max. Torque		Balancer Cap. (lbs)	Clamp Dia.	Angle		
		American	S.I.			0°	22.5°	45°
EZ-12RPC	260165	8.8 lbf.ft	12 N.m	1.1 - 2.6	1 - 1 1/2"	15 1/8" - 21"	14 1/2" - 20"	12 1/3" - 18"
EZ-25RPC	260156	18.4 lbf.ft	25 N.m	2.2 - 4.8	1 - 2"	15 1/8" - 21"	15" - 20 1/2"	12 7/8" - 18 1/2"
EZ-40RPC	260157	29.5 lbf.ft	40 N.m	3.1 - 4.8	1 - 2"	22 1/4" - 30"	21 1/8" - 29"	18 1/8" - 26"
EZ-100RPC	260158	73.7 lbf.ft	100 N.m	4.4 - 7.7	1 - 2"	26 1/3" - 34"	25 1/8" - 33"	22" - 29 1/2"

## Cables

For connecting power tools to DPC-Touch Posi-Control System, select cable below.

Description	Item #
ECD, ECTD & MDC Controller	310162
STC30 Plus, STC40	260159
HDC & SDC Controller	260161



## Model:

DPC-Touch Posi-Control System V2

Item # 260290

## EZ-GLIDER POSITION CONTROL TELESCOPING TORQUE ARM

- Ergonomic torque arms absorb the torque reaction emitted from power tools
- Safeguard against fastening failures by ensuring that every screw is in the correct location at the right torque.
- Programmable sequence operation
- Traceability and error-proofing. Real-time monitoring
- Detects - cross-threading, omissions, unfinished rundowns and cycle complete. Keeps tool perpendicular
- Digital I/O signals for communication with external devices such as PLC
- Quick and easy to setup. Self-teaching and automation program mode
- Programmable: Positioning tolerance, Min. and Max. time for poka-yoke control (automatic or manual) and 99 memory points
- Compatible with DC Controlled Tools, electric screwdrivers
- Requires DPC-Touch Posi-Control System
- Ergonomic torque arms absorb the torque reaction emitted from power tools
- The lightweight, durable carbon fiber the arm collapses like a telescope
- Easy-to-use requires little space and doesn't disrupt production flow
- The effortless handling of the torque arm provides comfortable tool operation and increases production



### APC models

Equipped with one angle coder



Models	Item #	Max. Torque American	Max Torque S.I.	Clamp Dia.	Min Arm Reach	Max Arm Reach
EZ-30T APC	260212	22.1 lbf.ft	30 N.m	1 - 2"	18.7"	37.5"
EZ-30T/1500 APC	260213	22.1 lbf.ft	30 N.m	1 - 2"	25.8"	59"
EZ-30T/2000 APC	260214	22.1 lbf.ft	30 N.m	1 - 2"	32.4"	78.7"
EZ-80T/1500 APC	260215	59 lbf.ft	80 N.m	1 - 2"	28.1"	59"
EZ-80T/2000 APC	260216	59 lbf.ft	80 N.m	1 - 2"	34.6"	78.7"
EZ-140T/1500 APC	260217	103.3 lbf.ft	140 N.m	1 1/4 - 2"	36.5"	59"
EZ-140T/2000 APC	260218	103.3 lbf.ft	140 N.m	1 1/4 - 2"	46.4"	78.7"

### LPC models

Equipped with one cable length coder

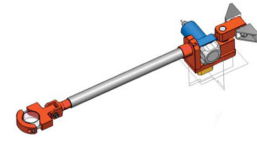

Models	Item #	Max. Torque American	Max Torque S.I.	Clamp Dia.	Min Arm Reach	Max Arm Reach
EZ-30T LPC	260219	22.1 lbf.ft	30 N.m	1 - 2"	18.7"	37.5"
EZ-30T/1500 LPC	260220	22.1 lbf.ft	30 N.m	1 - 2"	25.8"	59"
EZ-30T/2000 LPC	260221	22.1 lbf.ft	30 N.m	1 - 2"	32.4"	78.7"
EZ-80T/1500 LPC	260222	59 lbf.ft	80 N.m	1 - 2"	28.1"	59"
EZ-80T/2000 LPC	260223	59 lbf.ft	80 N.m	1 - 2"	34.6"	78.7"
EZ-140T/1500 LPC	260224	103.3 lbf.ft	140 N.m	1 1/4 - 2"	36.5"	59"
EZ-140T/2000 LPC	260225	103.3 lbf.ft	140 N.m	1 1/4 - 2"	46.4"	78.7"

### LAPC models

Equipped with one cable length coder & one angle coder

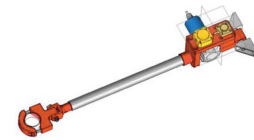

Models	Item #	Max. Torque American	Max Torque S.I.	Clamp Dia.	Min Arm Reach	Max Arm Reach
EZ-30T LAPC	260226	22.1 lbf.ft	30 N.m	1 - 2"	18.7"	37.5"
EZ-30T/1500 LAPC	260227	22.1 lbf.ft	30 N.m	1 - 2"	25.8"	59"
EZ-30T/2000 LAPC	260228	22.1 lbf.ft	30 N.m	1 - 2"	32.4"	78.7"
EZ-80T/1500 LAPC	260229	59 lbf.ft	80 N.m	1 - 2"	28.1"	59"
EZ-80T/2000 LAPC	260230	59 lbf.ft	80 N.m	1 - 2"	34.6"	78.7"
EZ-140T/1500 LAPC	260231	103.3 lbf.ft	140 N.m	1 1/4 - 2"	36.5"	59"
EZ-140T/2000 LAPC	260232	103.3 lbf.ft	140 N.m	1 1/4 - 2"	46.4"	78.7"



**Note!** It is recommended to use a tool balancer with all EZ-Glider Position Control Telescoping Arm models. Tool balancer is not included with torque arm.

The telescoping arms should not be used at maximum arm reach on a permanent basis.

### Cables

For connecting power tools to DPC-Touch Posi-Control System, select cable below.

Description	Item #
ECD, ECTD & MDC Controller	310162
STC30 Plus, STC40	260159
HDC & SDC Controller	260161



### Model:

DPC-Touch Posi-Control System V2

Item # 260290



## Tool Positioning Options:

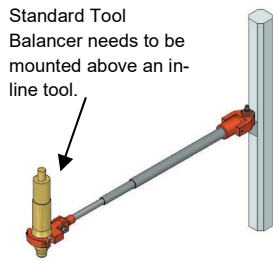

Besides the standard in-line tool mounting position, the position control telescoping arm can be used with assembly tools in a variety of positions. For some tool positioning options, different tool clamp needs to be ordered separately. Balancing Kit not included with torque arm.

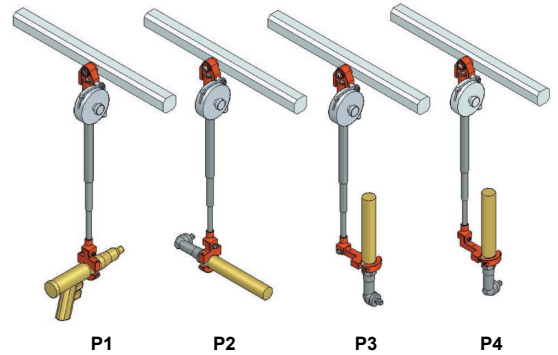

Models	P1	P2	P3	P4
EZ-30T	Yes	Yes, Order Clamp #260144	Yes, Order Clamp #260145	Yes, Order Clamp #260146
EZ-80T	Yes	Yes	Yes	Yes, Order Clamp #260148
EZ-140T	Yes	Yes	Yes	Yes, Order Clamp #260148

## Accessories

### Standard Gliding Rail System

The Telescoping Torque Arms can be mounted to the Standard Gliding Rail System (sold separately) and can be used in a variety of positions. For a vertical position it is necessary to install one additional item, an interface bracket (sold separately).

Working Distance	Item #
450 mm	260103
650 mm	260104
850 mm	260105
1050 mm	260106
1350 mm	260107
1850 mm	260108

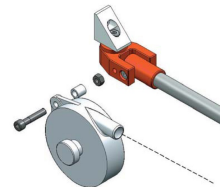

### Balancing Kits for Vertical Mounting

For EZ-30T, 80T and 140T models  
A balancing kit can be mounted on the side of any telescoping arm. It allows the arm to be used with pistol grip tools and angle nutrunners (see tool position options above)

### Interface Bracket

Item # 260051

For a EZ-30T, 80T and 140T models mounted to the Standard Gliding Rail system.

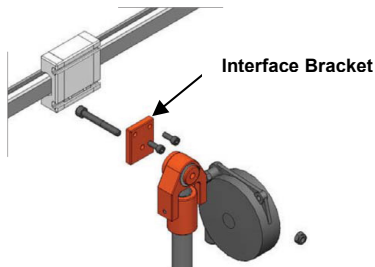

Item #	Balancer Capacity	Stroke
260140	2.2 - 4.4 lbs.	63"
260141	2.2 - 5.5 lbs.	78.75"
260142	4.4 - 8.8 lbs.	78.75"
260143	8.8 - 13.2 lbs.	78.75"

# MSP-SERIES SCREW PRESENTERS

- The screw presenter is ideal for automation and robotic manufacturing applications. It operates in combination with a robotic screw driving system that is equipped with a vacuum attachment to pick up a screw from the presenter screw guide.
- Screws are poured into the hopper of the screw presenter and automatically lined up for dispensing.
- This simple mechanism allows trouble-free operation, eliminating jammed or stuck screws.
- An inexpensive screw presenter is an alternative tool instead of the cumbersome and costly screw feeder systems.
- The unit is flexible to adjust for different screw sizes. Adjustable vibration and speed settings.
- Optimizes the manufacturing process with efficiency by mechanically presenting a screw to a fixed pick-up point
- The compact system can fit into any work environment for easy accessibility and provides virtually maintenance-free operation.



Model	Item #	Max Screw Head Dia. "D"	Screw Size Capacity "d"	Max Screw Head Height "t"	Max Screw Length "L"
MSP-812A	144797	6mm	M0.8 - M2.0	3mm	8mm
MSP-616	144778	11mm	M1.2 - M5.0	9mm	15mm
MSP-1070	144781	13mm	M1.7 - M6.0	10mm	24mm

**Note!** Screw Presenter requires the use of magnetized bit with the power tool.

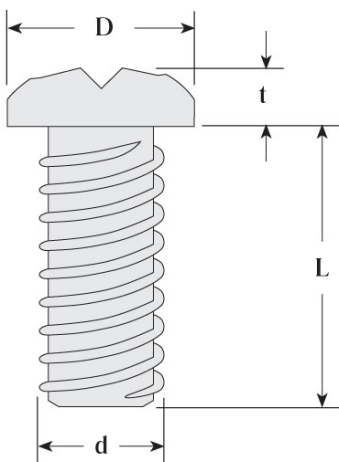

## Related Products

### Mag-O-nets

Place on a bit to magnetize.



### Scout II

Error-proofing device to detect and eliminate costly screw-fastening errors.



## MSP-SERIES AUTOMATION SCREW PRESENTERS

- The automation screw presenter is ideal for robotic manufacturing applications. Operates in combination with automation & robotic screw driving systems.
- Screws are poured into the hopper of the screw presenter and automatically lined up for dispensing.
- This simple mechanism allows trouble-free operation, eliminating jammed or stuck screws.
- The cost-effective automated screw presenter is an alternative machine instead of the cumbersome and costly screwfeeder systems.
- Smoothly feeds screws. Adjustable vibration and speed settings.



Models	Item	Screw Size Capacity "d"	Max Screw Head Height "t"	Max Screw Head Dia. "D"	Max Screw Length "L"
MSP812M	144798	M0.8 - M2.0	3mm	6mm	8mm
MSP619-10	144783	M1.0	0.2 - 6	1.2 - 12	1.0 - 14
MSP619-12	144784	M1.2	0.2 - 6	1.2 - 12	1.0 - 14
MSP619-14	144786	M1.4	0.2 - 6	1.2 - 12	1.0 - 14
MSP619-16	144785	M1.6	0.2 - 6	1.2 - 12	1.0 - 14
MSP619-18	144787	M1.8	0.2 - 6	1.2 - 12	1.0 - 14
MSP619-20	144788	M2.0	0.2 - 6	1.2 - 12	1.0 - 14
MSP619-23	144789	M2.3	0.2 - 6	1.2 - 12	1.0 - 14
MSP619-25	144790	M2.5	0.2 - 6	1.2 - 12	1.0 - 14
MSP619-26	144791	M2.6	0.2 - 6	1.2 - 12	1.0 - 14
MSP619-27	144792	M2.7	0.2 - 6	1.2 - 12	1.0 - 14
MSP619-30	144795	M3.0	0.2 - 6	1.2 - 12	1.0 - 14
MSP619-35	144793	M3.5	0.2 - 6	1.2 - 12	1.0 - 14
MSP619-40	144794	M4.0	0.2 - 6	1.2 - 12	1.0 - 14
MSP-1069G	144796	M4.0	0.2 - 6	1.2 - 12	1.0 - 20

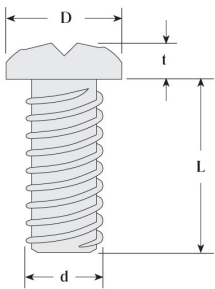

**Note!** Screw Presenter requires the use of a vacuum attachment with the power tool.

# WEBINARS ON ASSEMBLY POWER TOOLS

Mountz, The Torque Tool Specialists®, has been a leader in the torque tool industry for more than 57 years. We have experienced a breadth of manufacturing environments and gathered various perspectives. View our on-demand torque educational webinars to learn more about implementing assembly power tools into your manufacturing processes.



## How to Select an Electric Screwdriver for Your Manufacturing Process

How do you select the proper power tool for your application? Watch our torque webinar and learn about choosing the best power tool for your manufacturing process.



## Learn 5 Key Error-Proofing Assembly Process Techniques

Mistake proofing is the quickest path to zero defects and is a critical enabler for efficient manufacturing. Watch our torque webinar and learn five best practices for error-proofing the fastening process.



## How to Test a Power Tool Calibration & Reliability

How often do you verify a power tool calibration and repeatable performance? Watch our torque webinar and learn how to measure dynamic torque and validate a power tool's calibration and repeatability.



## How to Ensure Screws are Tightened in the Correct Fastening Sequence

Did you know that an incorrect screw fastening sequence can provide unreliable results? Watch our torque webinar and learn how to implement an assembly process that ensures all the fasteners are installed and tightened to the correct fastening sequence.



## Implement Error-Proofing & Process Control with SMART Cordless Screwdrivers

Controlling variables and eliminating manufacturing risks are essential enablers for efficient manufacturing. Watch our torque webinar and learn how to implement error-proofing techniques and enhance process reliability with a cordless screwdriver.



## Torque 101 - A Guide to the Fundamentals of Torque Control

Watch our torque webinar and learn what torque is, the variables that impact it, and methods for applying and measuring torque.



## Improve Production Efficiency by Implementing a Screw Counting Process

This process is an error-proofing technique to detect and eliminate costly screw-fastening errors. Watch our torque webinar and learn how to implement a screw counting process to verify that all fasteners were installed and tightened to the correct torque specification.