

MOUNTZ HAND TOOLS



TABLE OF CONTENTS

Products	Page
FG Preset Torque Screwdrivers	3
FG-IFR Preset Torque Screwdrivers	4
FG-OWC Preset Torque Screwdrivers	5
FGA Adjustable Torque Screwdrivers	6
Crowfoot Spanner Heads	7
PTL Torque Limiters	8
FGC Cam-Over Wrenches	9
TB Break-Over Wrenches	10
TBIH Break-Over Wrenches	13
MMTB Break-Over Wrenches	16
TBX Break-Over Wrenches	17
EPT Adjustable Click Wrenches	20
IPT Preset Click Wrenches	21
Insulated Torque Wrenches	22
Webinars on Hand Tools	23

FG PRESET TORQUE SCREWDRIVER

- Poka-yoke torque screwdriver prevents over-torque. Cam-over technology ensures correct torque is applied and eliminates fastener breakage issues
- Preset screwdriver ensures that the correct torque value is consistently applied to each fastener
- Delivers repeatability, traceability and precision for all tightening applications
- Four different color-coding label options allows for torque setting identification in the manufacturing area
- Tamper-proof internal adjustment. No external adjustment scale—must be preset using a torque analyzer
- Designed and manufactured to meet or exceed the accuracy and repeatability requirements of ISO 6789: 2017 (+/- 6% of setting)



Model	Item #	Torque Ranges		Label Color	Drive Size	Weight	Length
		American	S.I.				
FG-25z	076705	3 – 25 ozf.in	2 – 17.7 cN.m	Blue	1/4" F/Hex	2.8 oz.	4.1"
FG-25z	076706	3 – 25 ozf.in	2 – 17.7 cN.m	Red	1/4" F/Hex	2.8 oz.	4.1"
FG-25z	076707	3 – 25 ozf.in	2 – 17.7 cN.m	Green	1/4" F/Hex	2.8 oz.	4.1"
FG-25z	076708	3 – 25 ozf.in	2 – 17.7 cN.m	Gold	1/4" F/Hex	2.8 oz.	4.1"
FG-8i	076546	0.8 – 8 lbf.in	9 – 90 cN.m	Blue	1/4" F/Hex	7.3 oz.	5.2"
FG-8i	076551	0.8 – 8 lbf.in	9 – 90 cN.m	Red	1/4" F/Hex	7.3 oz.	5.2"
FG-8i	076556	0.8 – 8 lbf.in	9 – 90 cN.m	Green	1/4" F/Hex	7.3 oz.	5.2"
FG-8i	076561	0.8 – 8 lbf.in	9 – 90 cN.m	Gold	1/4" F/Hex	7.3 oz.	5.2"
FG-20i	076547	2 – 20 lbf.in	22 – 226 cN.m	Blue	1/4" F/Hex	7.3 oz.	5.2"
FG-20i	076552	2 – 20 lbf.in	22 – 226 cN.m	Red	1/4" F/Hex	7.3 oz.	5.2"
FG-20i	076557	2 – 20 lbf.in	22 – 226 cN.m	Green	1/4" F/Hex	7.3 oz.	5.2"
FG-20i	076562	2 – 20 lbf.in	22 – 226 cN.m	Gold	1/4" F/Hex	7.3 oz.	5.2"
FG-40i*	076548	4 – 40 lbf.in	0.4 – 4.5 N.m	Blue	1/4" F/Hex	11.5 oz.	6.3"
FG-40i*	076553	4 – 40 lbf.in	0.4 – 4.5 N.m	Red	1/4" F/Hex	11.5 oz.	6.3"
FG-40i*	076558	4 – 40 lbf.in	0.4 – 4.5 N.m	Green	1/4" F/Hex	11.5 oz.	6.3"
FG-40i*	076563	4 – 40 lbf.in	0.4 – 4.5 N.m	Gold	1/4" F/Hex	11.5 oz.	6.3"
FG-125i*	076549	25 – 125 lbf.in	2.8 – 14.1 N.m	Blue	1/4" F/Hex	11.5 oz.	6.3"
FG-125i*	076554	25 – 125 lbf.in	2.8 – 14.1 N.m	Red	1/4" F/Hex	11.5 oz.	6.3"
FG-125i*	076559	25 – 125 lbf.in	2.8 – 14.1 N.m	Green	1/4" F/Hex	11.5 oz.	6.3"
FG-125i*	076564	25 – 125 lbf.in	2.8 – 14.1 N.m	Gold	1/4" F/Hex	11.5 oz.	6.3"

Note! * A removable, sliding T-bar is supplied with FG-40i and FG-125i models.

FG-IFR PRESET TORQUE SCREWDRIVER

- Low impact poka-yoke torque screwdriver prevents over-torque and vibration on sensitive components
- Preset screwdriver ensures that the correct torque value is consistently applied to each fastener
- Calibration life 4x ISO standards, unmatched by any torque screwdriver
- Industry leading warranty: 2 years unconditional. Lifetime against defects
- Four different color-coding label options allows for torque setting identification in the manufacturing area
- Tamper-proof internal adjustment. No external adjustment scale—must be preset using a torque analyzer. Screwdriver is torque limiting and calibrated in the CW direction only
- Designed and manufactured to meet or exceed the accuracy and repeatability requirements of ISO 6789: 2017 (+/- 6% of setting)



Model	Item #	Torque Ranges		Label Color	Drive Size	Weight	Length
		American	S.I.				
FG-8i FR	076651	0.8 – 8 lbf.in	9 – 90 cN.m	Blue	1/4" F/Hex	7.3 oz.	5.2"
FG-8i IFR	076656	0.8 – 8 lbf.in	9 – 90 cN.m	Red	1/4" F/Hex	7.3 oz.	5.2"
FG-8i IFR	076661	0.8 – 8 lbf.in	9 – 90 cN.m	Green	1/4" F/Hex	7.3 oz.	5.2"
FG-8i IFR	076666	0.8 – 8 lbf.in	9 – 90 cN.m	Gold	1/4" F/Hex	7.3 oz.	5.2"
FG-20i IFR	076652	2 – 20 lbf.in	22 – 226 cN.m	Blue	1/4" F/Hex	7.3 oz.	5.2"
FG-20i IFR	076657	2 – 20 lbf.in	22 – 226 cN.m	Red	1/4" F/Hex	7.3 oz.	5.2"
FG-20i IFR	076662	2 – 20 lbf.in	22 – 226 cN.m	Green	1/4" F/Hex	7.3 oz.	5.2"
FG-20i IFR	076667	2 – 20 lbf.in	22 – 226 cN.m	Gold	1/4" F/Hex	7.3 oz.	5.2"
FG-40i IFR*	076653	4 – 40 lbf.in	0.4 – 4.5 N.m	Blue	1/4" F/Hex	11.5 oz.	6.3"
FG-40i IFR*	076658	4 – 40 lbf.in	0.4 – 4.5 N.m	Red	1/4" F/Hex	11.5 oz.	6.3"
FG-40i IFR*	076663	4 – 40 lbf.in	0.4 – 4.5 N.m	Green	1/4" F/Hex	11.5 oz.	6.3"
FG-40i IFR*	076668	4 – 40 lbf.in	0.4 – 4.5 N.m	Gold	1/4" F/Hex	11.5 oz.	6.3"
FG-125i IFR*	076654	25 – 125 lbf.in	2.8 – 14.1 N.m	Blue	1/4" F/Hex	11.5 oz.	6.3"
FG-125i IFR*	076659	25 – 125 lbf.in	2.8 – 14.1 N.m	Red	1/4" F/Hex	11.5 oz.	6.3"
FG-125i IFR*	076664	25 – 125 lbf.in	2.8 – 14.1 N.m	Green	1/4" F/Hex	11.5 oz.	6.3"
FG-125i IFR*	076669	25 – 125 lbf.in	2.8 – 14.1 N.m	Gold	1/4" F/Hex	11.5 oz.	6.3"

Note! * A removable, sliding T-bar is supplied with FG-40i IFR and FG-125i IFR models.

FG-OWC PRESET TORQUE SCREWDRIVER

- A one-way torque clutch system is designed to apply torque in one direction and remains positive (no torque control) in the opposite direction. This allows the tool to be used for easy screw removal. Ideal for maintenance and refurbishing applications and where undoing or loosening screws is required.
- Poka-yoke torque screwdriver prevents over-torque. Cam-over technology ensures correct torque is applied and eliminates fastener breakage issues
- Preset screwdriver ensures that the correct torque value is consistently applied to each fastener
- Calibration life 4x ISO standards, unmatched by any torque screwdriver
- Industry leading warranty: 2 years unconditional. Lifetime against defects
- Tamper-proof internal adjustment. No external adjustment scale—must be preset using a torque analyzer. Screwdriver is torque limiting and calibrated in the CW direction only
- Designed and manufactured to meet or exceed the accuracy and repeatability requirements of ISO 6789: 2017 (+/- 6% of setting)



Model	Item #	Torque Ranges		Label Color	Drive Size	Weight	Length
		American	S.I.				
FG-8i OWC	076586	0.8 – 8 lbf.in	9 – 90 cN.m	Blue	1/4" F/Hex	7.3 oz.	5.2"
FG-8i OWC	076591	0.8 – 8 lbf.in	9 – 90 cN.m	Red	1/4" F/Hex	7.3 oz.	5.2"
FG-8i OWC	076596	0.8 – 8 lbf.in	9 – 90 cN.m	Green	1/4" F/Hex	7.3 oz.	5.2"
FG-8i OWC	076601	0.8 – 8 lbf.in	9 – 90 cN.m	Gold	1/4" F/Hex	7.3 oz.	5.2"
FG-20i OWC	076587	2 – 20 lbf.in	22 – 226 cN.m	Blue	1/4" F/Hex	7.3 oz.	5.2"
FG-20i OWC	076592	2 – 20 lbf.in	22 – 226 cN.m	Red	1/4" F/Hex	7.3 oz.	5.2"
FG-20i OWC	076597	2 – 20 lbf.in	22 – 226 cN.m	Green	1/4" F/Hex	7.3 oz.	5.2"
FG-20i OWC	076602	2 – 20 lbf.in	22 – 226 cN.m	Gold	1/4" F/Hex	7.3 oz.	5.2"
FG-40i OWC*	076588	4 – 40 lbf.in	0.4 – 4.5 N.m	Blue	1/4" F/Hex	11.5 oz.	6.3"
FG-40i OWC*	076593	4 – 40 lbf.in	0.4 – 4.5 N.m	Red	1/4" F/Hex	11.5 oz.	6.3"
FG-40i OWC*	076598	4 – 40 lbf.in	0.4 – 4.5 N.m	Green	1/4" F/Hex	11.5 oz.	6.3"
FG-40i OWC*	076603	4 – 40 lbf.in	0.4 – 4.5 N.m	Gold	1/4" F/Hex	11.5 oz.	6.3"
FG-125i OWC*	076589	25 – 125 lbf.in	2.8 – 14.1 N.m	Blue	1/4" F/Hex	11.5 oz.	6.3"
FG-125i OWC*	076594	25 – 125 lbf.in	2.8 – 14.1 N.m	Red	1/4" F/Hex	11.5 oz.	6.3"
FG-125i OWC*	076599	25 – 125 lbf.in	2.8 – 14.1 N.m	Green	1/4" F/Hex	11.5 oz.	6.3"
FG-125i OWC*	076604	25 – 125 lbf.in	2.8 – 14.1 N.m	Gold	1/4" F/Hex	11.5 oz.	6.3"

Note! * A removable, sliding T-bar is supplied with FG-40i and FG-125i models.

FGA ADJUSTABLE TORQUE SCREWDRIVER

- Quick torque setting adjustment
- Poka-yoke torque screwdriver prevents over-torque
- Cam-over technology ensures that the correct torque value is consistently applied
- Digital torque scale provides an accurate and simplistic process to adjust the torque setting
- Calibration life 4x ISO standards, unmatched by any adjustable screwdriver
- Select the torque measurement setting for your application
- Designed and manufactured to meet or exceed the accuracy and repeatability requirements of ISO 6789: 2017 (+/- 6% of setting)



Torque Ranges

Model	Item #	American ozf.in	American lbf.in	S.I. cN.m	S.I. N.m	Metric kgf.cm	Drive Size	Weight
FGA-8	076720	25.6 - 128	1.6 - 8	18 - 90	0.18 - 0.9	1.8 - 9.2	1/4" F/Hex	13 oz.
FGA-20	076721	32 - 320	2 - 20	22 - 226	0.22 - 2.3	2.3 - 23	1/4" F/Hex	13.1 oz
FGA-40	076722	64 - 640	4 - 40	45.2 - 452	0.4 - 4.5	4.6 - 46	1/4" F/Hex	13.3 oz.
FGA-80	076723	-----	8 - 80	-----	2.8 - 14.1	9.2 - 92	1/4" F/Hex	13.3 oz.

Units of torque measurement

Select the torque measurement setting for your application.

FGA-8, FGA-20, AND FGA-40
Five options available:

- ozf.in
- lbf.in
- cN.m
- N.m
- kgf.cm

FGA-80 MODEL
Three options available:

- lbf.in
- N.m
- kgf.cm

Removable sliding T-bar supplied with FGA-40 and FGA-80 models.



PTL PRESET TORQUE LIMITER

- Various models that range from 1 to 85 lbf.in.
- Designed to be used in-line to limit torque for hand (static) applications. For low torque applications.
- Can also be used as an overload protection device on most applications where measuring a static overload is needed.
- The rotary clutch mechanism slips free when the pre-set torque value is reached, eliminating overtightening. The mechanism then automatically resets.
- Pre-set using a torque analyzer.
- Bi-directional operation and are calibrated in either the CW or CCW direction.
- Lightweight and easy-to-use.
- Repeatability within +/- 6% of pre-set torque value.



Model	Item #	Torque Ranges		Input Drive	Output Drive
		American	S.I.		
PTL 4.5i	280060	1 - 4.5 lbf.in	11.3 - 50.9 cN.m	3/8" F/Sq	1/4" F/Hex
PTL 5i-Q	280062	1 - 5 lbf.in	11.3 - 56.5 cN.m	3/8" F/Sq	3/8" M/Sq
PTL 45i	280061	9.1 - 45 lbf.in	102.8 - 508.5 cN.m	3/8" F/Sq	1/4" F/Hex
PTL 45i-Q	280063	9.1 - 45 lbf.in	102.8 - 508.5 cN.m	3/8" F/Sq	3/8" M/Sq
PTL 85i-Q	280064	45 - 85 lbf.in	58.5 - 960.5 cN.m	3/8" F/Sq	3/8" M/Sq

Note! Do not use with a power tool.

CROWFOOT SPANNER HEADS

- The correct tightening of SMA connectors used in RF cabling applications is essential to ensure optimum performance
- Crowfoot spanner allows vertical access to places where conventional torque tools cannot be used
- Use in combination with preset and adjustable hand torque screwdrivers
- Accurately tightening RF, COAX and SMA connectors with torque screwdrivers
- Ability to remove connectors without removing the adjacent cables
- Designed for small, tight fits
- Suitable for most standard sizes of all the major connector manufacturers



Length

Models	in	mm	Item #
1/4" Crowfoot Spanner	3	76.2	061670
5/16" Crowfoot Spanner	3	76.2	061628
3/8" Crowfoot Spanner	3	76.2	061585
7/16" Crowfoot Spanner	3	76.2	061621
1/2" Crowfoot Spanner	3	76.2	061622
5mm Crowfoot Spanner	3	76.2	061624
8mm Crowfoot Spanner	3	76.2	061619
14mm Crowfoot Spanner	3	76.2	061623
17mm Crowfoot Spanner	3	76.2	061647
18mm Crowfoot Spanner	3	76.2	061625
19mm Crowfoot Spanner	3	76.2	061626

Length

in	mm	Item #
5	127	066100
5	5	066101
5	5	066103
5	5	066104
5	5	066105
5	5	066102
-	-	-
5	5	066106
5	5	066107
5	5	066108
5	5	066109

Related Products



FG Preset Screwdrivers

Attach a crowfoot spanner to a preset screwdrivers for manufacturing applications.



FGA Adjustable Screwdrivers

Attach a crowfoot spanner to an adjustable screwdrivers for field service and maintenance applications.

FGC PRESET CAM-OVER WRENCH

- Poka-yoke torque wrench prevents over-torque, as a click wrench cannot
- Cam-over technology ensures correct torque is applied and eliminates fastener breakage issues
- Preset screwdriver ensures that the correct torque value is consistently applied to each fastener
- Delivers repeatability, traceability and precision for all tightening applications
- Calibration life 2x ISO standards, unmatched by any torque wrench
- Industry leading warranty: 2 years unconditional. Lifetime against defects



FGC-5 and FGC-10 models

- Designed and manufactured to meet or exceed the accuracy and repeatability requirements of ISO 6789: 2017 (+/- 6% of setting)

FGC-30, FGC-75 and FGC-125 models

- Designed and manufactured to meet or exceed the accuracy and repeatability requirements of ISO 6789: 2017 (+/- 4% of setting)

Model	Item #	Torque Ranges		Drive Size	Length	Weight
		American	S.I.			
FGC-5	076565	8.9 - 44.2 lbf.in	1 - 5 N.m	1/4" Sq. Dr.	7.8"	1 lb.
FGC-10D	076566	17.7 - 88.5 lbf.in	2 - 10 N.m	1/4" Sq. Dr.	7.8"	1 lb.
FGC-10A	076567	17.7 - 88.5 lbf.in	2 - 10 N.m	3/8" Sq. Dr.	7.8"	1 lb.
FGC-30D	076568	4.4 - 22.1 lbf.ft	6 - 30 N.m	1/4" Sq. Dr.	12.8"	2 lbs.
FGC-30A	076569	4.4 - 22.1 lbf.ft	6 - 30 N.m	3/8" Sq. Dr.	12.8"	2 lbs.
FGC-75	076570	11.1 - 55.3 lbf.ft	15 - 75 N.m	3/8" Sq. Dr.	17.5"	3 lbs.
FGC-125	076571	18.5 - 92.2 lbf.ft	25 - 125 N.m	1/2" Sq. Dr.	17.5"	3 lbs.



Tamper-proof internal adjustment. No external adjustment scale—must be preset using a torque analyzer

TB BREAK-OVER WRENCH

- The preset wrench ensures that the correct torque value is consistently applied to each fastener. Designed to have fixed head permanently attached.
- Breaks-over upon reaching preset torque. Improves the fastening process by reducing the risk of both over and under-tightening.
- Delivers repeatability, traceability, and precision for all tightening applications.
- Six different colored aluminum handles allow for color-coding of specific torque values in production areas.
- No external adjustment scale—must be preset using a torque analyzer
- Designed and manufactured to meet or exceed the accuracy and repeatability requirements of ISO 6789: 2017 (+/- 6% of setting)



TB Wrench Configuration

These configurable wrenches are made to order. To construct the TB wrench you will need to select four elements to configure the product's part number.

Part Number Order Example:

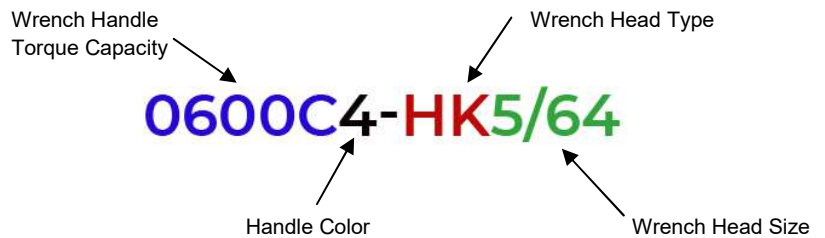

Step 1 - Select TB Wrench Handle Torque Capacity

Configuration Number	Torque Ranges	
	American	S.I.
0600A	25 - 50 ozf.in	17.7 - 35.3 cN.m
0600B	3 - 12 lbf.in	33.9 - 135.6 cN.m
0600C	12 - 21 lbf.in	135.6 - 237.3 cN.m
0600D	25 - 50 lbf.in	226 - 565 cN.m

Step 2 - Select TB Wrench Handle Color

TB Handle Color	Configuration Number
Black	1
Blue	2
Red	3
Green	4
Gold	5
Silver	6

TB Wrench Configuration

Step 3 - Select TB Wrench Head Type

Head Type	Configuration Number
Open End	OE
Box End	BE
Hex Key	HK
Flare End	FE
Ratchet	RH

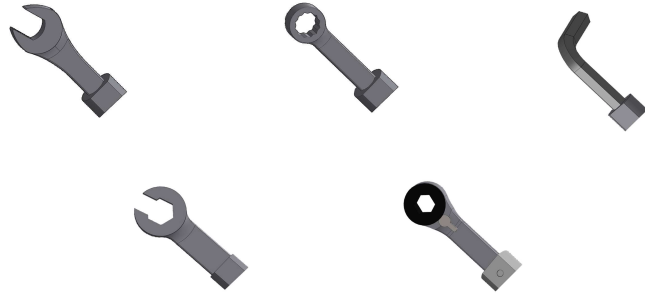

Step 4 - Select TB Wrench Head Size

Open End

American Configuration Number	Metric Configuration Number
5/64	3 mm
1/8	4 mm
9/64	5 mm
5/32	5.5 mm
3/16	6 mm
13/64	6.5 mm
7/32	7 mm
15/64	8 mm
1/4	8.5 mm
9/32	9 mm
5/16	10 mm
11/32	11 mm
3/8	12 mm
13/32	13 mm
7/16	14 mm
1/2	15 mm
9/16	17 mm
5/8	18 mm
11/16	19 mm
3/4	20 mm
13/16	21 mm
7/8	22 mm



Box End

American Configuration Number	Metric Configuration Number
1/8	5 mm
5/32	6 mm
3/16	7 mm
7/32	8 mm
1/4	9 mm
9/32	10 mm
5/16	11 mm
11/32	12 mm
3/8	13 mm
7/16	17 mm
1/2	
9/16	
5/8	
11/16	
3/4	



TB Wrench Configuration

Step 4 - Select TB Wrench Head Size

Hex Key

American Configuration Number	Metric Configuration Number
-------------------------------	-----------------------------

0.05	1.5 mm
1/16	2 mm
5/64	2.5 mm
3/32	3 mm
7/64	3.5 mm
1/8	4 mm
9/64	5 mm
5/32	
3/16	
7/32	
1/4	
3/8	
7/16	
3/4	



Flare End

American Configuration Number	Metric Configuration Number
-------------------------------	-----------------------------

1/4	13 mm
5/16	15 mm
3/8	17 mm
7/16	19 mm
1/2	
9/16	
11/16	
3/4	
13/16	



Ratchet Head

American Configuration Number

1/4 F/Hex



Note! 52 Teeth 1/4 inch Female Hex

TBIH BREAK-OVER WRENCH

- The preset wrench ensures that the correct torque value is consistently applied to each fastener. Designed to be compatible with different head options like open end, box end, flare end, hex key end, or a ratchet head
- Breaks-over upon reaching preset torque. Improves the fastening process by reducing the risk of both over and under-tightening.
- Delivers repeatability, traceability, and precision for all tightening applications.
- Six different colored aluminum handles allow for color-coding of specific torque values in production areas.
- No external adjustment scale—must be preset using a torque analyzer
- Designed and manufactured to meet or exceed the accuracy and repeatability requirements of ISO 6789: 2017 (+/- 6% of setting)

Handle Color						
Item #	Item #	Item #	Item #	Item #	Item #	Torque Ranges
068000-A	068001-A	068002-A	068003-A	068004-A	067999-A	25 - 50 ozf.in
068000-B	068001-B	068002-B	068003-B	068004-B	067999-B	3 - 12 lbf.in
068000-C	068001-C	068002-C	068003-C	068004-C	067999-C	12 - 21 lbf.in
068000-D	068001-D	068002-D	068003-D	068004-D	067999-D	20 - 50 lbf.in

Related Products



Torque Analyzers

A preset wrench doesn't have an external torque adjustment scale and must be preset using a torque analyzer. Measure and calibrate tools with a torque analyzer

Note! TBIH models have a break angle range up to 90°.

TBIH Interchangeable Heads

Mountz offers a range of imperial and metric wrench head fittings for the TBIH break-over wrenches. Open ends, box head ends, flare ends, hex key, and a ratchet end can be supplied to suit almost every application. Contact our technical support team if you require a custom size or have an application with limited space access.

Open End



American

Size	Item #
5/64"	068115
1/8"	068100
9/64"	068180
5/32"	068101
3/16"	068102
13/64"	068314
7/32"	068103
15/64"	068215
1/4"	068104
9/32"	068105
5/16"	068106
11/32"	068107
3/8"	068108
13/32"	068098
7/16"	068109
1/2"	068110
9/16"	068111
5/8"	068112
11/16"	068114
3/4"	068113
13/16"	068099
7/8"	068042

Metric

Size	Item #
3 mm	068159
4 mm	068202
5 mm	068139
5.5 mm	068046
6 mm	068140
6.5 mm	068160
7 mm	068141
8 mm	068142
8.5 mm	068149
9 mm	068143
10 mm	068144
11 mm	068145
12 mm	068146
13 mm	068147
14 mm	068148
15 mm	068136
17 mm	068237
18 mm	068222
19 mm	068208
20 mm	068199
21 mm	068138
22 mm	068209

Hex Key



American

Size	Item #
0.05"	068175
1/16"	068174
5/64"	068162
3/32"	068163
7/64"	068164
1/8"	068165
9/64"	068166
5/32"	068167
3/16"	068168
7/32"	068169
1/4"	068170
3/8"	068171
7/16"	068172
3/4"	068173

Metric

Size	Item #
1.5 mm	068236
2 mm	068181
2.5 mm	068182
3 mm	068183
3.5 mm	068184
4 mm	068185
5 mm	068186

TBIH Interchangeable Heads

Box End



American

Size In	Item #
1/8	068120
5/32	068121
3/16	068122
7/32	068123
1/4	068124
9/32	068125
5/16	068126
11/32	068127
3/8	068128
7/16	068129
1/2	068130
9/16	068131
5/8	068132
11/16	068133
3/4	068134

Metric

Size In	Item #
5 mm	068313
6 mm	068150
7 mm	068151
8 mm	068152
9 mm	068153
10 mm	068154
11 mm	068155
12 mm	068156
13 mm	068157
17 mm	068137

Flare End



American

Size In	Item #
1/4	068188
5/16	068189
3/8	068187
7/16	061553
1/2	068198
9/16	068190
11/16	068320
3/4	068235
13/16	068321

Metric

Size In	Item #
13 mm	068232
15 mm	068194
17 mm	068355
19 mm	068298

Ratchet Head



Size In	Item #
---------	--------

1/4" F/Hex 060034

MMTB MINIATURE BREAK-OVER WRENCH

- The miniature preset wrench ensures that the correct torque value is consistently applied to each fastener. Designed to have fixed head permanently attached.
- Breaks-over upon reaching preset torque. Improves the fastening process by reducing the risk of both over and under-tightening.
- Delivers repeatability, traceability, and precision for all tightening applications.
- Small with lightweight aluminum handle (3/8" dia. x approx.- 3 1/2" overall length).
- No external adjustment scale—must be preset using a torque analyzer
- Designed and manufactured to meet or exceed the accuracy and repeatability requirements of ISO 6789: 2017 (+/- 6% of setting)



MMTB Wrench Configuration

These configurable wrenches are made to order. To order a MMTB wrench you will need to provide three items.

Step 1 - Select MMTB Wrench Handle with Torque Capacity

Option A: 8 - 39 ozf.in (5.6 - 27.5 cN.m)

Option B: 40 - 80 ozf.in (28.2 - 56.4 cN.m)

Step 2 - Specify Head Type

Step 3 - Specify Head Size

Step 4 - Preset Torque Value (optional*)

Note! * A torque analyzer is needed if select to preset a torque value yourself for the wrench.

Head Type	Head Size Ranges
OE (Open End)	7/32" to 3/4"
BH (Box Head)	1/4" to 3/4"
FN (Flare Nut)	1/3" to 9/16"
HK (Hex Key)	1/16" to 5/32"
RH (Ratchet Head)	1/4" F/Hex

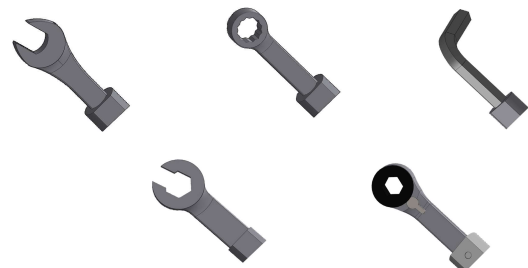

TBX BREAK-OVER WRENCH

- Torque limiting wrench improves control of the tightening process.
- Reduces the risk of both over and under-tightening.
- Break-over mechanism provides a visual indicator of achieving torque setting.
- Calibration life 4x ISO standards.
- Preset wrench ensures that the correct torque value is consistently applied to each fastener.
- Tamper-proof internal adjustment. No external adjustment scale - must be preset using a torque analyzer.
- Delivers repeatability, traceability, and precision for tightening applications.
- Interchangeable end fitting design—selectable head types and sizes (open end, box head, hex key, fixed square drive heads and ratchet head)
- Interchangeable heads are manufactured with a common centerline, so the torque setting remains the same when head sizes are changed.
- Designed and manufactured to meet or exceed the accuracy and repeatability requirements of ISO 6789: 2017 (+/- 4% of setting).



Torque Ranges

Models	Item #	American	S.I.	Drive Size	Length	Break
TBX-12	076815	21.2 - 106.2 lbf.in	2.4 - 12 N.m	Type A	6"	20° or 90°
TBX-12 ESD	076818	21.2 - 106.2 lbf.in	2.4 - 12 N.m	Type A	6"	20° or 90°
TBX-25	076816	44.3 - 221.3 lbf.in	5 - 25 N.m	Type B	10.4"	20°
TBX-25 ESD	076819	44.3 - 221.3 lbf.in	5 - 25 N.m	Type B	10.4"	20°

Related Products



Torque Analyzers

A preset wrench doesn't have an external torque adjustment scale and must be preset using a torque analyzer. Measure and calibrate tools with a torque analyzer

Note! Models operate in a single direction

Interchangeable heads for TBX-12 model type A end fitting

Open End Heads



American

Size In	Item #
3/16	068605
1/4	068606
5/16	068607
3/8	068608
7/16	068609
1/2	068610
9/16	068611
5/8	068612
11/16	068613
3/4	068614

Metric

Size mm	Item #
6 mm	068615
7 mm	068616
8 mm	068617
9 mm	068618
10 mm	068619
11 mm	068620
12 mm	068621
13 mm	068622
14 mm	068623
15 mm	068624

Hex Key Heads



American

Size In	Item #
1/16	068639
5/64	068640
3/32	068641
7/64	068642
1/8	068643
9/64	068644
5/32	068645
3/16	068646
1/4	068647

Metric

Size In	Item #
1.5 mm	068648
2 mm	068649
2.5 mm	068651
3 mm	068652
4 mm	068653
5 mm	068654

Box End Heads



American

Size In	Item #
7/32	068625
1/4	068626
5/16	068627
3/8	068628
7/16	068629
1/2	068630

Metric

Size In	Item #
7 mm	068631
8 mm	068632
9 mm	068633
10 mm	068634
11 mm	068635
12 mm	068636
13 mm	068637

Fixed Square Drive Heads

Size In	Item #
1/4 Sq. Dr.	068655
3/8 Sq. Dr.	068656



Ratchet Head

Size In	Item #
1/4 Sq. Dr.	068599



Box Ratchet Head

Size In	Item #
1/4 Box End	068598



Blank End Head

Size In	Item #
Blank End	068603



Interchangeable heads for TBX-25 model type B end fitting

Open End Heads



American

Size In	Item #
1/4	068657
5/16	068658
3/8	068659
7/16	068660
1/2	068661
9/16	068662
5/8	068663
11/16	068664
3/4	068665
13/16	068666
7/8	068667
15/16	068668
1	068669
1 1/16	068670
1 1/8	068671
1 1/4	068672

Metric

Size mm	Item #
7 mm	068673
8 mm	068674
9 mm	068675
10 mm	068676
11 mm	068677
12 mm	068678
13 mm	068679
14 mm	068680
17 mm	068681
19 mm	068682
22 mm	068683

Box End Heads



American

Size In	Item #
1/4	068684
5/16	068685
3/8	068686
7/16	068687
1/2	068688
9/16	068689
5/8	068690
3/4	068691
7/8	068692
15/16	068693

Metric

Size In	Item #
9 mm	068694
13 mm	068695
17 mm	068696
18 mm	068697

Ratchet Heads

Size In	Item #
3/8 Sq. Dr.	068698
1/2 Sq. Dr.	068699



Blank End Head

Size In	Item #
Blank End	068604



EPT ADJUSTABLE CLICK WRENCH

- Durable and robust for industrial fastening applications.
- Adjustable torque wrench with a square drive. Bi-directional ratchet head.
- External dual scale (American & S.I.) Graduation collar on the torque handle.
- Easy to read laser marked scale.
- Built with a robust steel shaft with high corrosion resistance.
- Lightly knurled non-slip grip.
- 60 tooth ratchet (for EPT100i). 48 tooth ratchet (for models EPT250i - EPT750F).
- Positive lock with spring-loaded pull-down ring.
- Positive click can be heard and felt when torque is reached.
- This adjustable click wrench is ideal for field service, maintenance or production environments.
- The preferred and certified ranges of these tools are in accordance with the requirements of ISO 6789 (+/- 4% of indicated setting).



Torque Ranges

Models	Item #	Torque Range		Grad. Scale		Drive Size
		American	S.I.	American	S.I.	
EPT100i	280050	20 - 100 lbf.in	2.8 - 11.9 N.m	0.5 lbf.in	0.1 N.m	1/4" Sq. Dr.
EPT250i-D	280033	50 - 250 lbf.in	6.2 - 28.8 N.m	1 lbf.in	0.1 N.m	1/4" Sq. Dr.
EPT250i-A	280034	50 - 250 lbf.in	6.2 - 28.8 N.m	1 lbf.in	0.1 N.m	3/8" Sq. Dr.
EPT75F	280035	15 - 75 lbf.ft	23.7 - 105.1 N.m	0.5 lbf.ft	0.5 N.m	3/8" Sq. Dr.
EPT150F	280036	10 - 150 lbf.ft	20.3 - 210.1 N.m	1 lbf.ft	1 N.m	1/2" Sq. Dr.
EPT250F	280037	30 - 250 lbf.ft	47.4 - 345.7 N.m	2 lbf.ft	2 N.m	1/2" Sq. Dr.
EPT400F	280038	80 - 400 lbf.ft	142.3 - 559.2 N.m	2.5 lbf.ft	2.5 N.m	3/4" Sq. Dr.
EPT550F	280039	110 - 550 lbf.ft	183 - 779.5 N.m	2.5 lbf.ft	5 N.m	3/4" Sq. Dr.
EPT750F	280040	150 - 750 lbf.ft	237.2 - 1050.6 N.m	5 lbf.ft	5 N.m	1" Sq. Dr.

Note! After being used, adjustable click torque wrenches should be turned back to minimum scale value. This helps to preserve the springs and ensures a longer product life cycle with high precision.

IPT PRESET CLICK WRENCH

- Durable and robust for industrial fastening applications.
- Preset wrench ensures that the correct torque value is consistently applied to each bolt.
- Tamper-proof internal adjustment. No external adjustment scale - must be preset using a torque analyzer. Requires Torque Adjusting Key (sold separately).
- Built with a robust steel shaft with high corrosion resistance.
- Lightly knurled non-slip grip.
- Bi-directional ratchet head (48 tooth ratchet).
- Positive click can be heard and felt when torque is reached.
- The preferred and certified ranges of these tools are in accordance with the requirements of ISO 6789 (+/- 4% of indicated setting).



Torque Ranges

Models	Item #	American	S.I.	Drive Size	Length	Weight lbs.
IPT 18	280041	3.7 - 18.4 lbf.ft	5 - 25 N.m	1/4" Sq. Dr.	8 7/8"	0.7
IPT 36	280042	7.4 - 36.9 lbf.ft	10 - 50 N.m	3/8" Sq. Dr.	11 7/8"	1.4
IPT 73	280043	14.8 - 73.8 lbf.ft	20 - 100 N.m	3/8" Sq. Dr.	14 3/4"	1.8
IPT 110	280044	22.1 - 110.7 lbf.ft	30 - 150 N.m	3/8" Sq. Dr.	15 1/4"	2.4
IPT 150	280045	29.5 - 147.6 lbf.ft	40 - 200 N.m	1/2" Sq. Dr.	19 2/3"	2.9
IPT 250	280046	44.3 - 250.9 lbf.ft	60 - 340 N.m	1/2" Sq. Dr.	23 1/8"	3.9
IPT 369	280047	73.8 - 369 lbf.ft	100 - 500 N.m	3/4" Sq. Dr.	34"	12.1
IPT 885	280048	171.1 - 885.6 lbf.ft	240 - 1200 N.m	1" Sq. Dr.	58 1/4"	13

Related Products



IPT Torque Adjusting Set Key

The IPT Torque Adjusting Set Key is required to adjust the internal torque setting for select models

Item # 280049

For: IPT 18 - IPT 250 models.

Note! A 3mm allen key, extension bar, and a ratchet wrench or handle are needed to adjust the internal torque setting for models: IPT 369 - IPT 885 models

INSULATED TORQUE WRENCHES

- Insulated Wrenches are for life-threatening high voltage and low voltage electrical assembly applications where over-torque conditions are not tolerated and operator safety is mandatory.
- Designed with nonconductive plastic insulation, the torque wrenches provide operators with the proper safety for fastening applications.
- The Insulated torque wrenches ensure proper torque control and eliminate the possibility of product failure due to shorting, arcing or other electrical damage.
- The 1000V Insulated torque wrenches are built to protect against voltages up to 1,000 volts making these torque tools ideal for use in electrically live situations for a wide range of industries.
- Adjustable torque wrench with a square drive.
- Designed and manufactured to meet or exceed the accuracy and repeatability requirements of ISO 6789: 2017 (+/- 4% of setting)



Models	Item #	American	S.I.	Drive Size	Length	Weight lbs.
SLO1/4I	060398	40 - 180 lbf.in	4 - 20 N.m	1/4" Sq. Dr.	8 5/8"	1.3
SLO3/8I	060113	40 - 180 lbf.in	4 - 20 N.m	1/4" Sq. Dr.	8 5/8"	1.3

Note! Meets IEC6900 Standards.

Related Products



Torque Analyzers

Measure and calibrate tools with a torque analyzer

WEBINARS ON HAND TOOLS

Mountz, The Torque Tool Specialists®, has been a leader in the torque tool industry for more than 57 years. We have experienced a breadth of manufacturing environments and gathered various perspectives. View our on-demand torque educational webinars to learn more about implementing hand tools into your manufacturing processes.



How to Calibrate a Torque Wrench and Screwdriver

You don't want to be surprised by a torque wrench or screwdriver deemed "out of calibration." Watch our torque webinar and learn more about the calibration process and international standard requirements for a torque screwdriver or wrench.



3 Ways to Prevent Over-Torque Failures with Cam-Over Wrench Technology

Implementing a solution that prevents over-torque events is critical to reduce scrap rate costs. Watch our torque webinar and learn three ways to prevent over-torque failures with cam-over wrench technology.



How to Select a Precision Torque Wrench? Click vs. Cam-Over Wrench Technology

Why is a click wrench susceptible to torque failures? Watch our torque webinar and learn how a cam-over wrench prevents over-torque events.



How to Achieve Effective Torque Measurement & Calibration Program

A torque measurement strategy involves reducing risk and ensuring conformity with quality standards & regulatory compliances. Watch our torque webinar and learn how to implement successful torque testing and calibration program.



Improve Error-Prone Manufacturing Processes with Torque Limiting Technology

Each class of hand tools relies on different torque limitation methods. Watch our torque webinar and learn about the various hand tool options available and the unique benefits each type provides.



Torque 101 - A Guide to the Fundamentals of Torque Control

Watch our torque webinar and learn what torque is, the variables that impact it, and methods for applying and measuring torque.



How Friction Impacts Torque and the Fastening Process

What is the relationship between torque and friction? Watch our torque webinar and learn more about friction in threaded fasteners, the variables that impact torque, and methods to achieve clamp load for a threaded fastener joint.